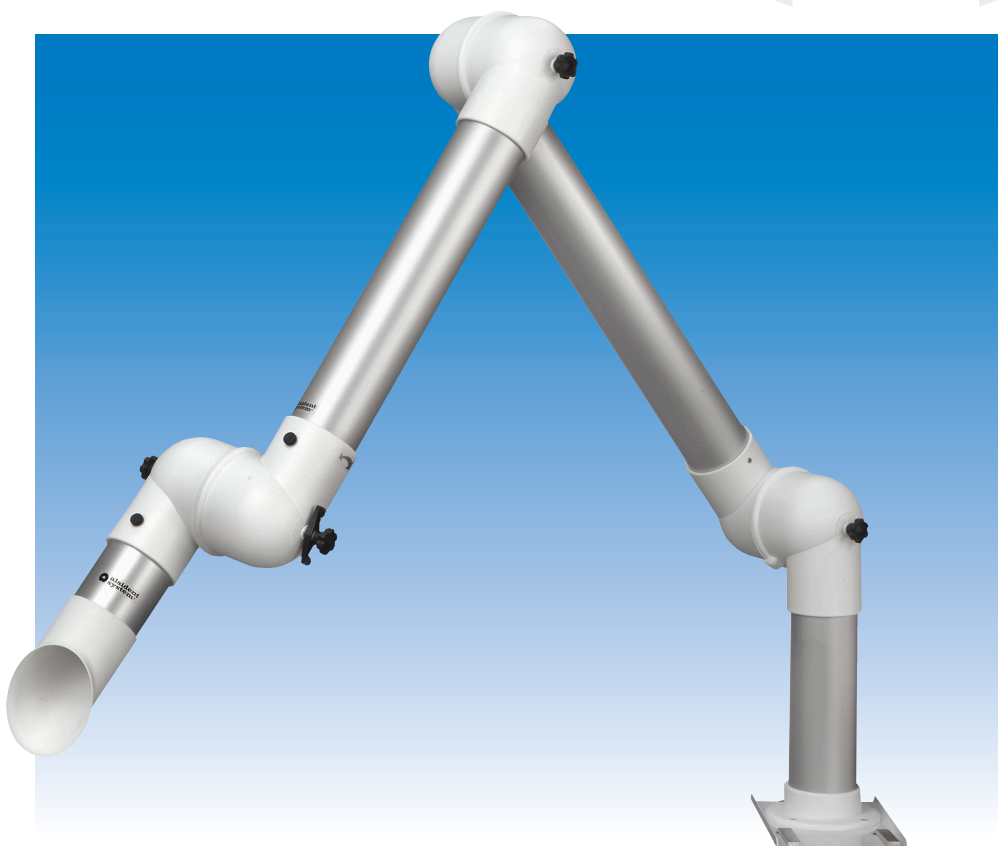


ALSIDENT® SYSTEM 75

Aluminium (AL)

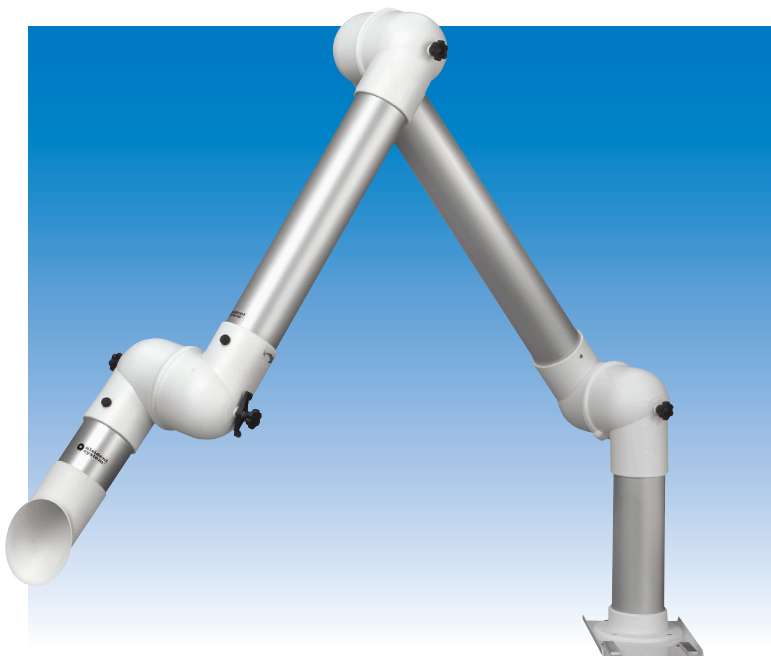


Product Information





Product Description



System 75 – Aluminium

Alsident® System 75 – airflow between 80 and 180 m³/h.

System 75 Aluminium is suitable in non-aggressive working environments where there are no special requirements for chemical resistance or antistatic abilities such as laboratories, laser technique, hospitals, chemical-, pharmaceutical- and food industry, schools and universities, electronics and engineering industries. In addition the System 75 Aluminium is also used in hairdressing saloons to extract vapours and gasses from hair-dyeing and permanent waving.

The standard Alsident® System 75 AL extraction arms are available in various types that are complementary to each other with ranges up to 1990 mm. The System 75 AL extraction arms are easily mounted with standard brackets for table, wall or ceiling. In combination with the wide range of hood designs this makes it possible to choose an extraction arm adapted for each work situation.

Alsident® System 75 AL extraction arms are self-sustaining with an internal bearing spring, joints of Polypropylen (PP) and tubes of anodized aluminium with a diameter of 75 mm. All internal components are of acid-proof stainless steel (AISI 316L). The two longest models for wall and ceiling mounted are available with both internal spring or external gas spring. The construction constitutes a very user-friendly extraction arm that is easy to adjust to the source of the pollutant during the working process.

An extraction arm from Alsident® System consists of three parts: An extraction arm, a hood and a mounting bracket. Each part must be ordered separately.

In addition to the standard range, Alsident® System 75 AL offers special customized solutions. The Alsident® technical department is always ready to help you find the best solution.

Alsident® offers short delivery time for both standard productions and special solutions.

Product Specification



Technical Specifications

Recommended Airflow:	Normal:	140 m ³ /h
	Minimum:	80 m ³ /h
	Maximum:	180 m ³ /h

Air Temperature:	-15°C – +90°C
-------------------------	---------------

Material:	Pipes:	Anodized Aluminium (10 µ)
	Joints:	Polypropylene (PP) – red or white
	O-rings:	Polyethylene (PE)
	Mounting Flanges:	Polypropylene (PP) – red or white
	Damper:	Polypropylene (PP)
	Thumbscrew:	Polypropylene (PP) – black
	Threaded Stay:	Acid-proof stainless steel (AISI 316L)
	Spring:	Acid-proof stainless steel (AISI 316L)
	Gas spring ¹⁾ :	Steel ²⁾

1) Available on 75-9065 and 75-9090

2) Also available in stainless steel on request

Abbr.:	PP:	Polypropylene <i>Shatterproof and chemical resistant</i>
	PE:	Polyethylene
	PETG:	Polyethylene Terephthalat, Glycol-modified <i>Transparent and resistant to solvents</i>

*Local Extraction for workplaces incl. all materials for mounting.
All components RoHS-compatible according to the directive 2002/95/EF (RoHS).*

Key to the signatures

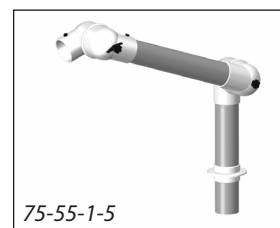
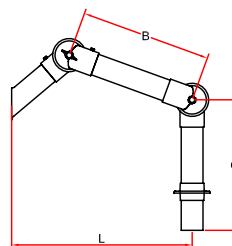
SYSTEM NO.	VERSION	CHAPTER	PAGE
75	AL Aluminium	GI General Information	01
		TM Table Mounted	
		WM Wall Mounted	
		CM Ceiling Mounted	

Product Overview

Table mounted

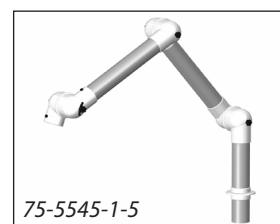
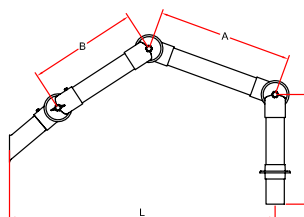


Table mounted (TM), 2-Joint



Diam. [mm]	L [mm]	B [mm]	C [mm]	Weight (appr.) [kg]	Part No.	Colour of joint	
						Red	White
75	550	350	450	1.5	75-35-1	-4	-5
75	650	450	450	2.0	75-45-1	-4	-5
75	750	550	450	2.3	75-55-1	-4	-5

Table mounted (TM), 3-Joint



Diam. [mm]	L [mm]	A [mm]	B [mm]	C [mm]	Weight (appr.) [kg]	Part No.	Colour of joint	
							Red	White
75	830	350	350	450	1.9	75-3535-1	-4	-5
75	1105	550	450	450	2.5	75-5545-1	-4	-5
75	1290	650	550	450	2.7	75-6555-1	-4	-5
75	1620	900	650	450	3.0	75-9065-1	-4	-5

SYSTEM 25

SYSTEM 50

SYSTEM 63

SYSTEM 75 AL

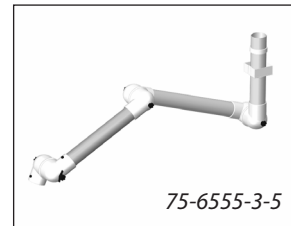
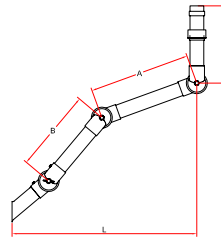
SYSTEM 100

Product Overview

Wall- and Ceiling Mounted



Wall- and Ceiling mounted (WM/CM), 3-Joint



Diam. [mm]	L [mm]	A [mm]	B [mm]	C [mm]	Weight (appr.) [kg]	Part No.	Colour of joint	
							Red	White
75	795	350	350	450	2.0	75-3535-3	-4	-5
75	1200	350	900	450	2.3	75-3590-3	-4	-5
75	1060	550	450	450	2.6	75-5545-3	-4	-5
75	1230	650	550	450	2.8	75-6555-3	-4	-5
75	1550	900	650	450	3.1	75-9065-3	-4	-5
75	1660	900	650	450	3.4	75-9065-3-22*	-4	-5
75	1730	900	900	450	3.6	75-9090-3	-4	-5
75	1990	900	900	450	3.8	75-9090-3-22**	-4	-5

*) With 1 external gas spring

**) With 2 external gas springs



Accessories Overview

Hoods – Suction Nozzle

Metal Hood (diam. 200 mm)

Part No.: 1-7524-4 /-5

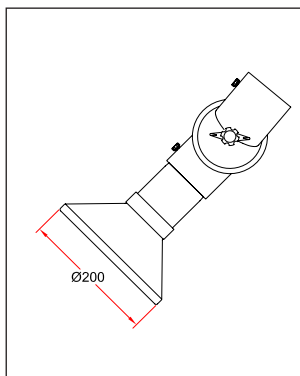
Recommended when extracting hot gases, fumes, light dust concentrations etc. The powder coated surface improves the durability of the hood.

Material

Metal hood: Aluminium (powder coated)
 Flange: Polypropylene (PP)¹
 Connection to tube: Aluminium (anodized – 10 µ)

Part No.	Red	White
1-7524	-4	-5

1) See page GI02



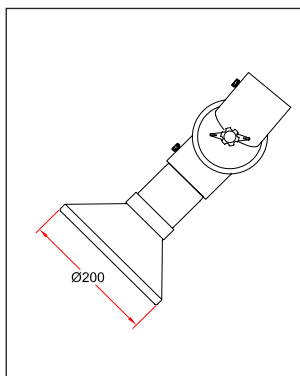
Metal Hood (diam. 200 mm)

Part No.: 1-7524

Recommended when extracting hot gases, fumes, light dust concentrations etc.
 Suitable for autoclaving.

Material

Hood: Aluminium (anodized – 10 µ)
 Flange: Aluminium (anodized – 10 µ)
 Connection to tube: Aluminium (anodized – 10 µ)



Suction Nozzle – width 200 mm

Part No.: 1-7525-4 /-5

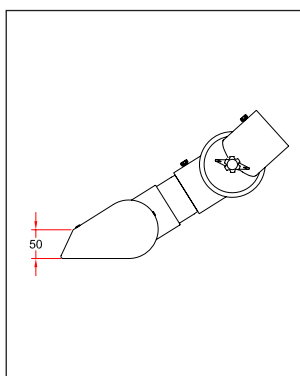
Recommended for concentrated sources of pollution. Efficient as it gets close to the source without obstructing the work process. Often used at soldering processes. Internal diffuser to increase efficiency.

Material

Suction Nozzle: Aluminium (anodized – 10 µ) and Polypropylene (PP)¹
 Flange: Polypropylene (PP)¹
 Connection to tube: Aluminium (anodized – 10 µ)

Part No.	Red	White
1-7525	-4	-5

1) See page GI02



SYSTEM 25

SYSTEM 50

SYSTEM 63

SYSTEM 75 AL

SYSTEM 100

Accessories Overview



SYSTEM 25

SYSTEM 50

SYSTEM 63

SYSTEM 75 AL

SYSTEM 100

Extractor Tube – Hood

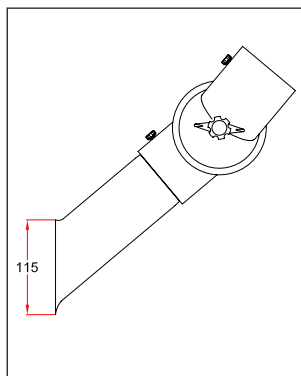
Extractor Tube – Aluminium

Part No.: 1-7525

Recommended for small concentrated sources of pollution. Efficient as it gets close to the source without obstructing the work process. Carefully made funnel increases the extraction efficiency.

Material

Tube: Aluminium (anodized – 10 µ)



Extractor Tube – Alu + Polypropylene (PP)

Part No.: 1-7526-4 /-5

Recommended for small concentrated sources of pollution. Efficient as it gets close to the source without obstructing the work process. Tip with funnel of Polypropylene increases the extraction efficiency.

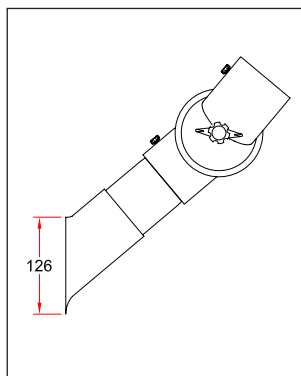
Material

Tube: Aluminium (anodized – 10 µ)

Spids: Polypropylene (PP)¹⁾

1) See page GI02

Part No.	Red	White
1-7526	-4	-5



Dome Hood (diam. 280 mm)

Part No.: 1-7528-4 /-5

Recommended for light fumes, gases and small open vessels. The transparent hood assists in keeping a good view of the workpiece. Increased stability due to reinforced rim of the hood. Increased efficiency at an angled position.

Material

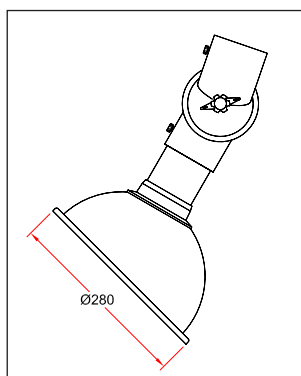
Hood: PETG¹⁾

Flange: Polypropylene (PP)¹⁾

Connection tube²⁾: Aluminium (anodized – 10 µ)

1) See page GI02

2) Separately enclosed at delivery



Part No.	Red	White
1-7528	-4	-5



Accessories Overview

Hoods – Extractor Tube

Dome Hood (diam. 385 mm)

Part No.: 1-7535-4 /-5

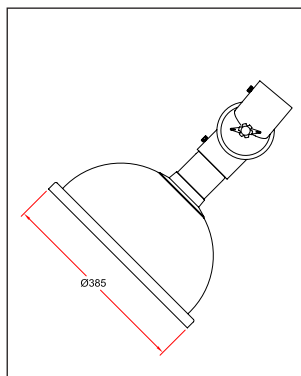
Recommended for light fumes, gases and small open vessels. The transparent hood assists in keeping a good view of the workpiece. Increased stability due to reinforced rim of the hood. Increased efficiency at an angled position.

Material

Hood: PETG¹
 Flange: Polypropylene (PP)¹
 Connection tube²: Aluminium (anodized – 10 µ)

1) See page GI02

2) Separately enclosed at delivery



Part No.	Red	White
1-7535	-4	-5

Flat Screen (330 x 240 mm)

Part No.: 1-753324-4 /-5

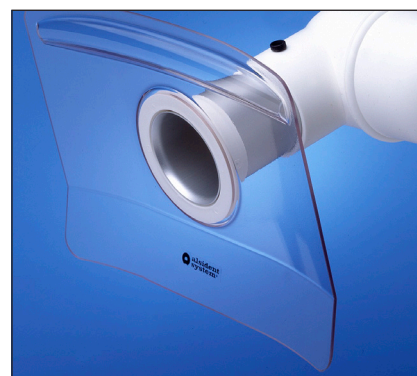
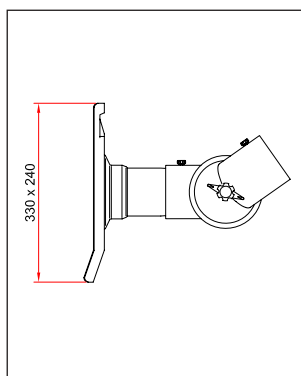
Recommended when extracting heavy gases and fumes. High efficiency when placed vertically on a surface e.g. a table. Practical rim for easy positioning of the hood. Gets close to the source without obstructing the work process.

Material

Hood: PETG¹
 Flange: Polypropylene (PP)¹
 Connection tube²: Aluminium (anodized – 10 µ)

1) See page GI02

2) Separately enclosed at delivery



Part No.	Red	White
1-753324	-4	-5

Square Hood (420 x 320 mm)

Part No.: 1-754232-4 /-5

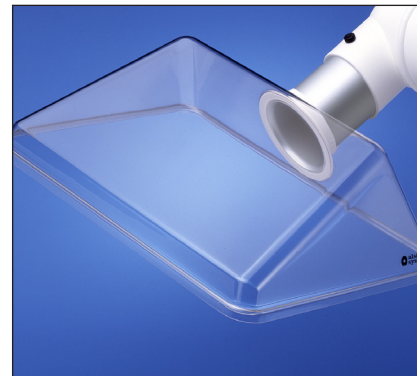
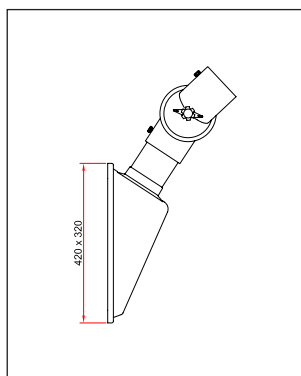
Recommended for both light and heavy fumes, gases and for open vessels, as this hood is suited for horizontal position above and vertical position behind the source of pollution. Good efficiency when placed vertically on a surface e.g. a table. Increased stability due to reinforced rim of the hood. The transparent hood assists in keeping a good view of the workpiece.

Material

Hood: PETG¹
 Flange: Polypropylene (PP)¹
 Connection tube²: Aluminium (anodized – 10 µ)

1) See page GI02

2) Separately enclosed at delivery



Part No.	Red	White
1-754232	-4	-5

Accessories Overview



Brackets

Wall bracket

Part No.: 2-195 and 2-195-10-5

Used for System 75 Wall Mounted Extraction Arms. The wall bracket is made of white polyester powder coated steel.

Other colours available on request.

② The bracket with both sides closed is suitable for all applications with special requirements to cleaning.

See photo page WM 03.

Colour	Open sides	Closed sides
White	2-195	2-195-10-5

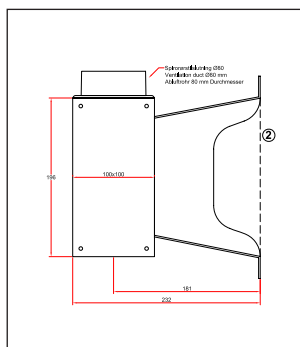
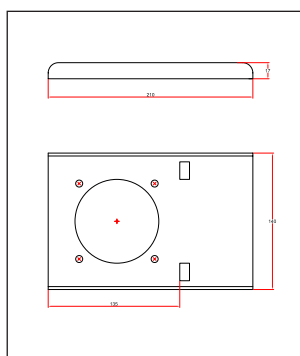


Table bracket

Part No.: 2-7510

Used to mount System 75 Table Mounted Extraction Arms on table side which makes it removable for mobile installations. Made of white polyester powder coated steel.

Other colours available on request.



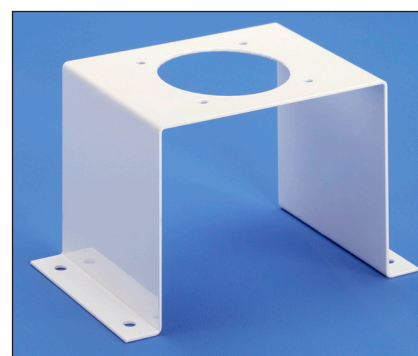
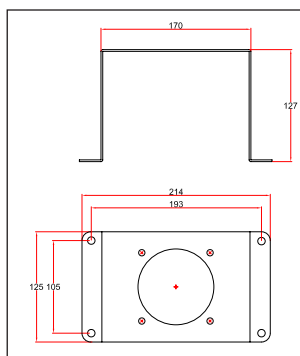
U-profile

Part No.: 30-75-5-4 /-5-5

Used for reinforcement of the socket pipe when table mounting a System 75 extraction arm in table plate. Made of steel with a white powder coated surface and an extra flange.

The flange is available in white or red. Other colours for the U-profile are available on request.

Colour of flange	Part No.
Red	30-75-5-4
White	30-75-5-5



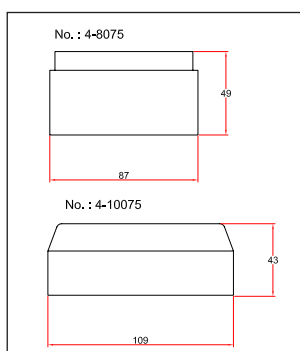
Reducers

Part No.: 4-10075 / 4-8075

Used to connect System75 Extraction Arms to duct. Made of white polypropylene (PP).

Available in two sizes.

Reducing from/to [mm]	Part No.
80/75	4-8075
100/75	4-10075



Accessories Overview

Brackets and Columns



Ceiling Columns

Used for mounting the System 75 Ceiling Mounted Extraction Arms. The ceiling column is made of white polyester powder coated steel.

Available in two models with side connection or top connection to duct.

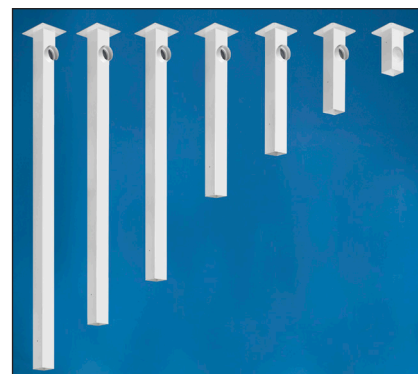
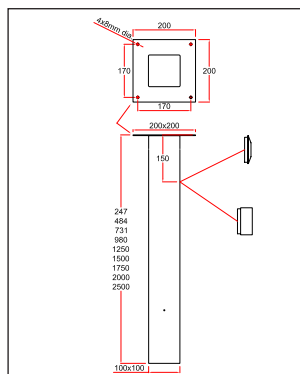
For standard lengths see below.

Other lengths, colours and acidproof stainless steel available on request.

Connection Diameter:

With side connection: 80 mm

With top connection: max. 100 mm


Top connection, Part No.:

Length [mm]	Weight app. [kg]	White	Black
250	2.0	2-250-20	2-250-050-20
500	3.0	2-500-20	2-500-050-20
750	3.8	2-750-20	2-750-050-20
1000	4.5	2-1000-20	2-1000-050-20
1250	5.4	2-1250-20	- *
1500	6.1	2-1500-20	- *
1750	7.1	2-1750-20	- *
2000	7.9	2-2000-20	- *
2500	9.4	2-2500-20	- *

Side connection, Part No.:

Length [mm]	Weight app. [kg]	White	Black
250	2.0	-	-
500	3.0	2-500-80	2-500-050-80
750	3.8	2-750-80	2-750-050-80
1000	4.5	2-1000-80	2-1000-050-80
1250	5.4	2-1250-80	- *
1500	6.1	2-1500-80	- *
1750	7.1	2-1750-80	- *
2000	7.9	2-2000-80	- *
2500	9.4	2-2500-80	- *

*) Black on request

Support Bracket for long ceiling column

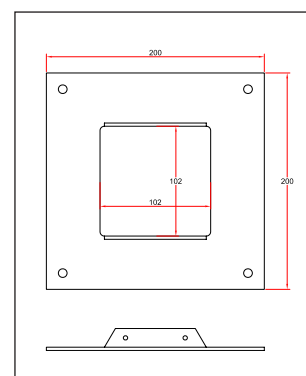
Part No.: 2-75-5

For extra support of ceiling columns longer than 2 m.

For support with wire to deck or by fastening to ceiling rail system.

The support bracket is made of steel with a white polyester powder-coating.

Other colours available on request.



SYSTEM 25

SYSTEM 50

SYSTEM 63

SYSTEM 75 AL

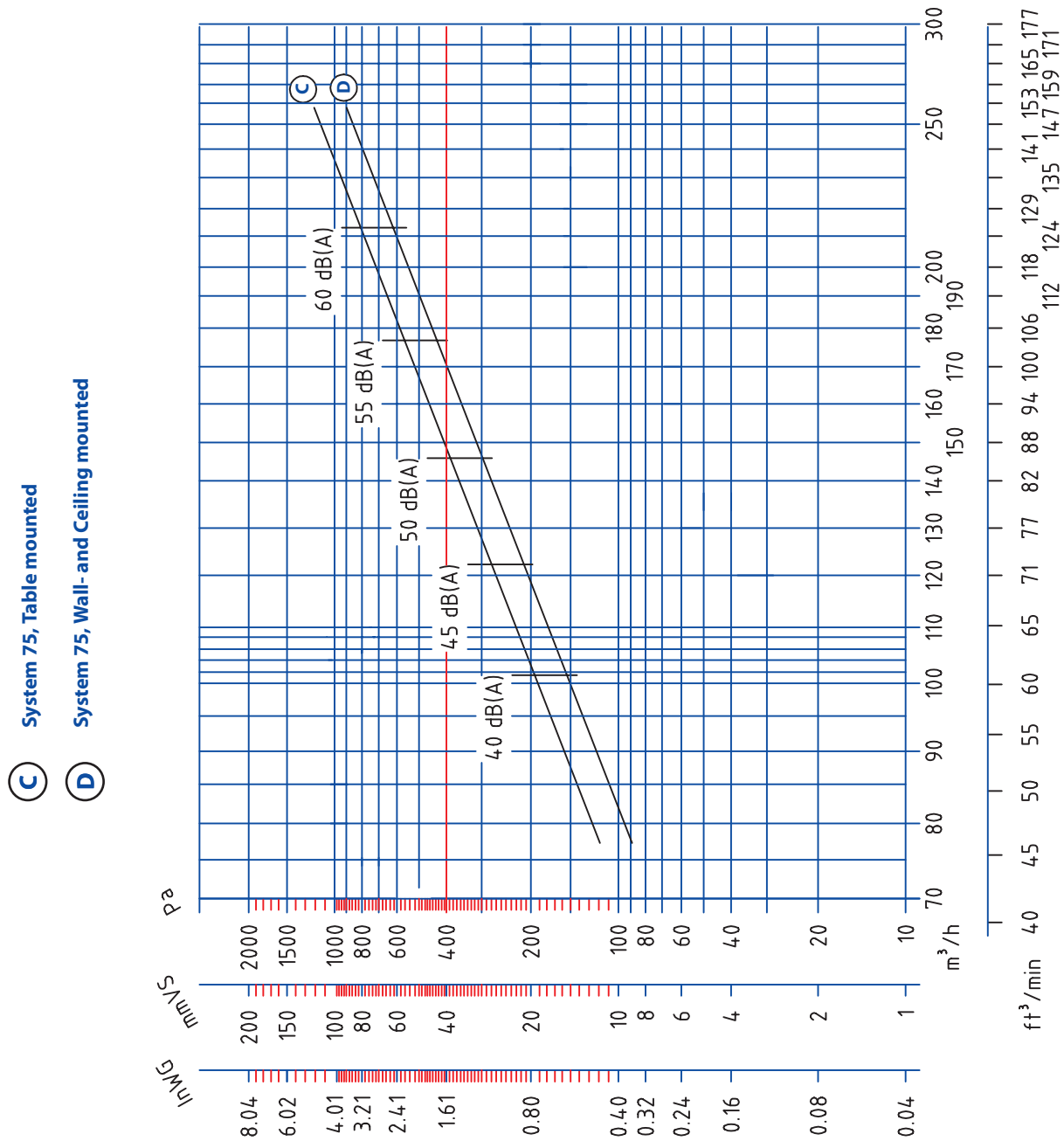
SYSTEM 100

Technical Description



Pressure Drop Chart

Tested by Danish Technological Institute



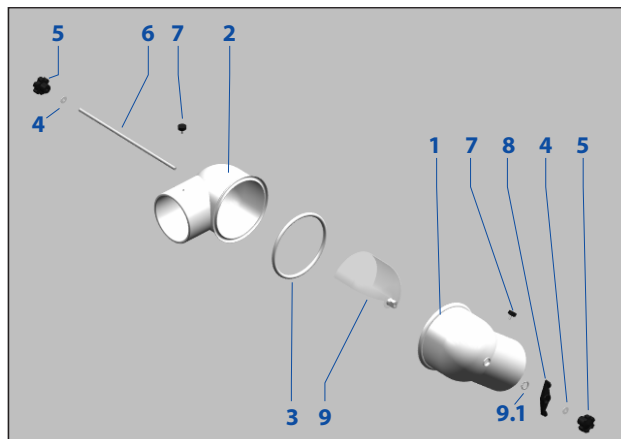
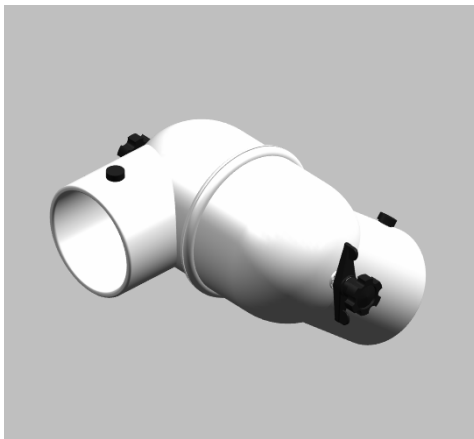
Spare Parts List

Joint with damper



Joint with Damper

4-75-4 /-5



Pos.

Product No.

A

4-75-4 /-5

Pos.	Part No.	Red	White	Description	A [pieces applied]
1	4-7512	-4	-5	Joint, 12 mm	1
2	4-755-0	-4	-5	Joint, 5 mm	1
3	5-100-6			O-ring	1
4	5-75			Teflon Washer	2
5	5-75-5			Thumbscrew, 5 mm	2
6	5-75-5-221			Threaded Stay	1
7	5-75-4			Thumbscrew, 4 mm	2
8	5-5075			Wing for damper	1
9	800-4-75			Damper	1
9.1	5-12-411			Seegerring	1

SYSTEM 25

SYSTEM 50

SYSTEM 63

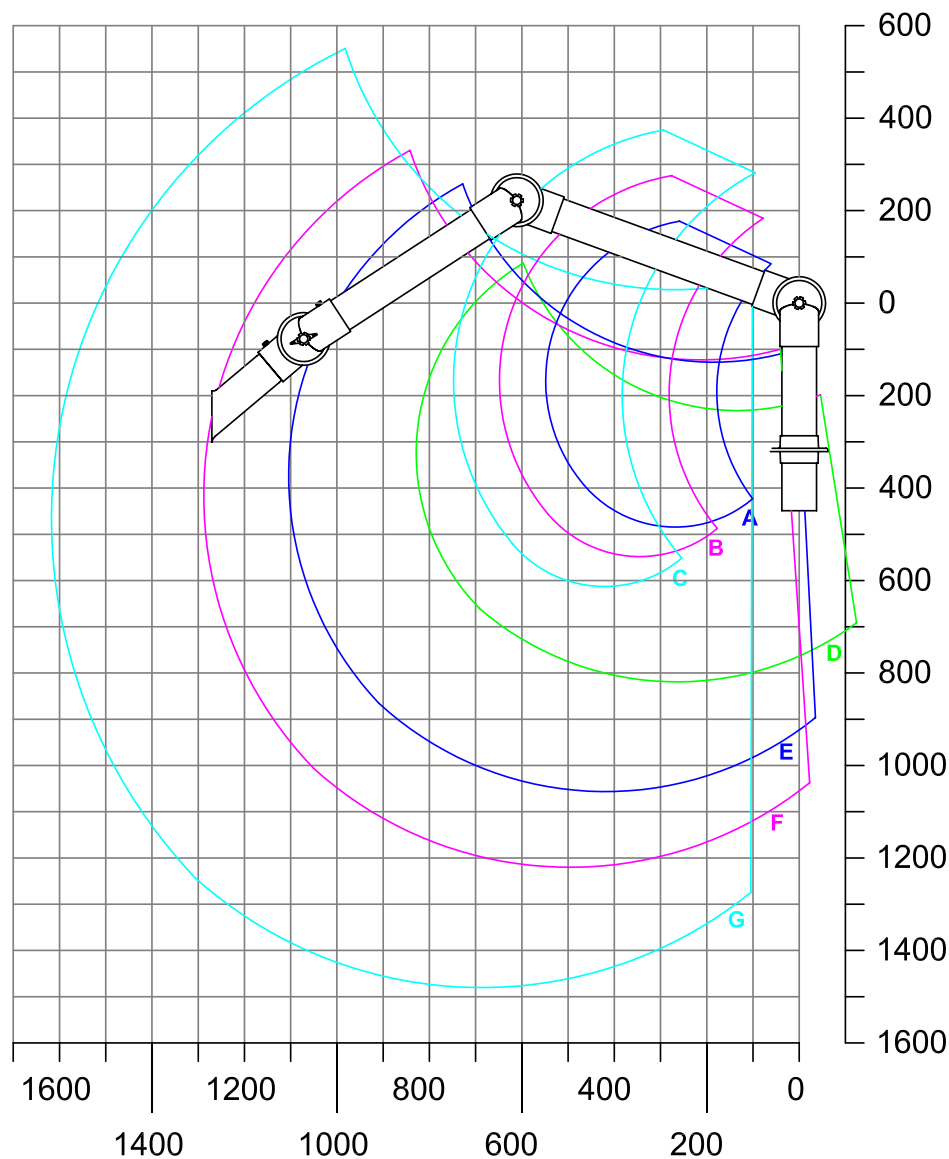
SYSTEM 75 AL

SYSTEM 100



Working Area

Table mounted with Extractor Tube



A: Model 75-35-1-4 /-5	R: 550 mm
B: Model 75-45-1-4 /-5	R: 650 mm
C: Model 75-55-1-4 /-5	R: 750 mm
D: Model 75-3535-1-4 /-5	R: 830mm
E: Model 75-5545-1-4 /-5	R: 1105 mm
F: Model 75-6555-1-4 /-5	R: 1290mm
G: Model 75-9065-1-4 /-5	R: 1620 mm

Accessory: Extractor Tube Nr. 1-7525

The working area of the arm is defined from the center of the opening of the accessory.

The working area changes according to type of accessory and positioning.

When choosing the arm we recommend that the stationary working position of the accessory is not placed in the highest or lowest part of the working area.

(All measurements in mm)



Table Mounted Option

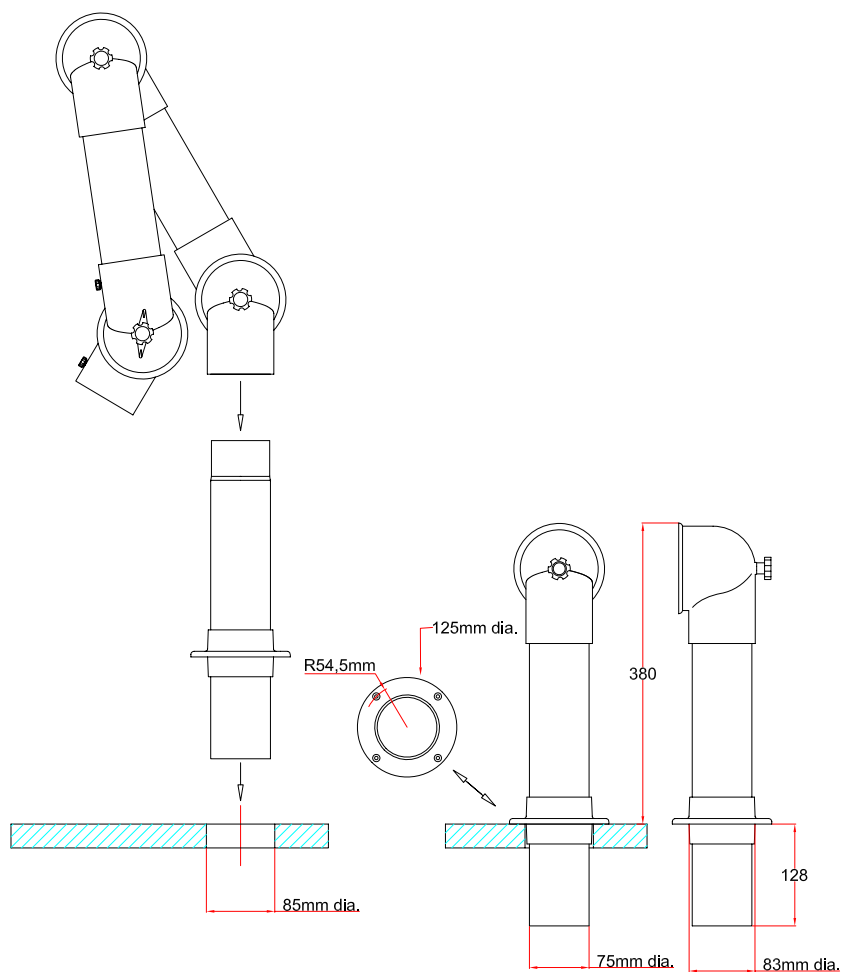
Directly on Table:

System 75 Extraction Arm mounted directly on table with flange screwed to table plate.

Accessory:

No brackets used.

Dimensions



(All measurements in mm)



Table Mounted Option with Table Bracket

With table bracket

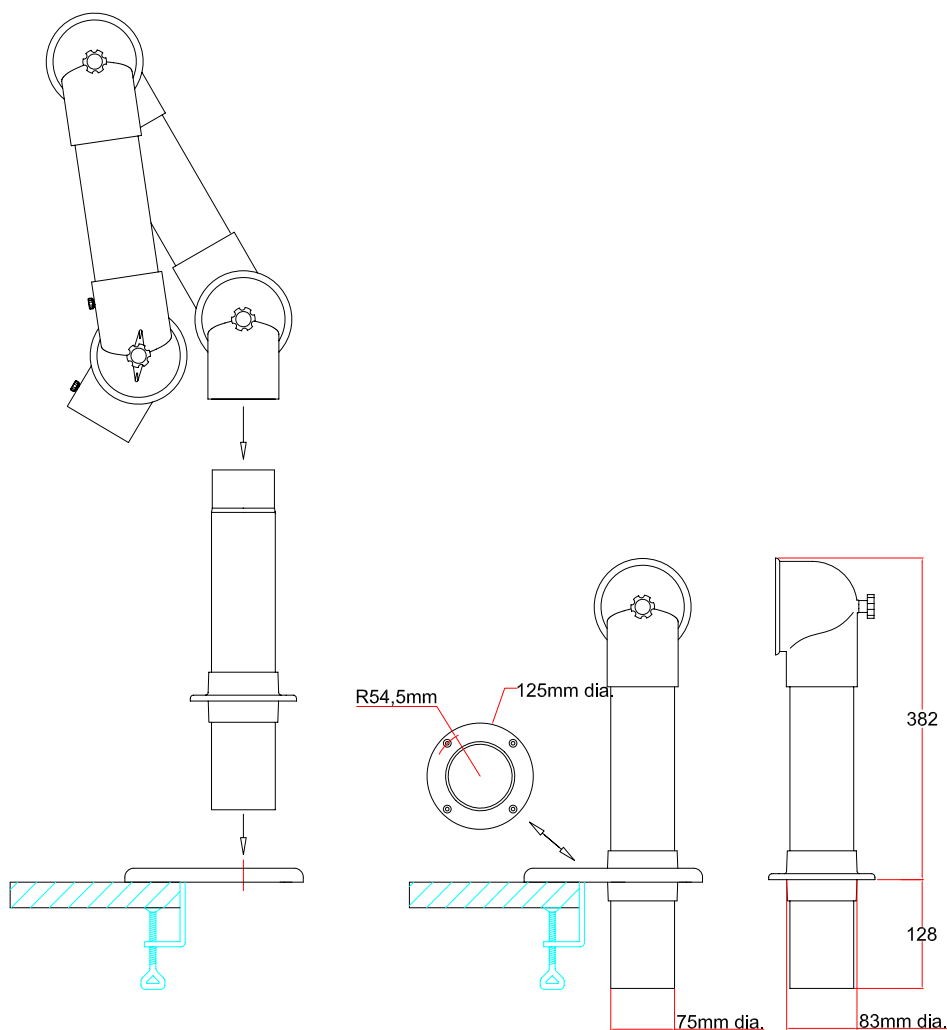
System 75 Extraction Arm mounted on table side with a table bracket.

Very functional option when impossible to mount directly on table or when a mobile installation is required.

Accessory:

Table Bracket, Part No.: 2-7510

Dimensions



(All measurements in mm)



Table Bracket

Technical Description

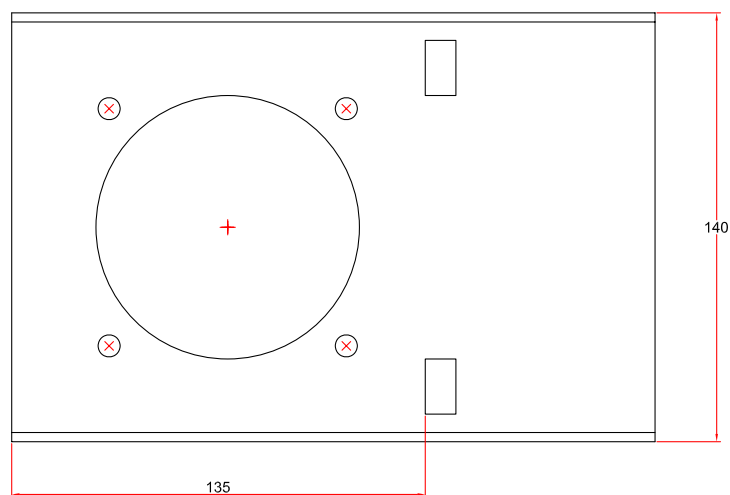
Part No.: 2-7510

Used to mount System 75 Table Mounted Arms on table side.
Removable for mobile installations. Made of white Polyester powder coated steel.

Other colours available on request.



Dimensions



(All measurements in mm)



Table mounted option with U-profile above table

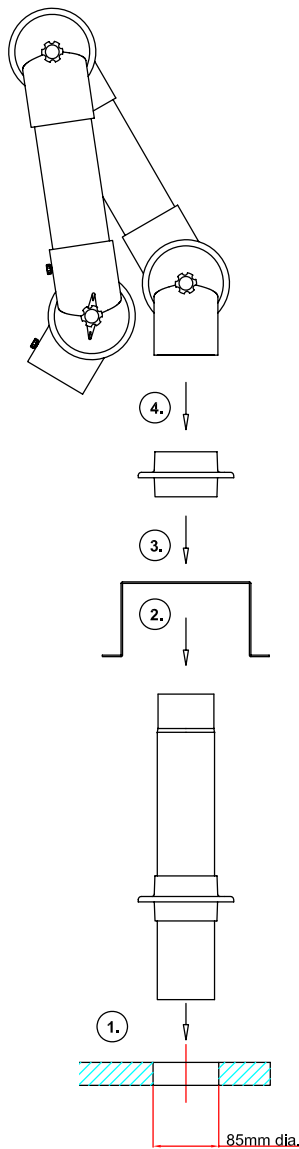
U-profile above table

System 75 mounted in table with U-profile above table.

Accessory

U-profile, Part No.: 30-75-5-4 /-5-5

Dimensioner



Mounting Instruction

1. Make a hole in the table with a max. diameter of 85 mm.
Mount the socket pipe on the table with the included screws.
2. Place the U-profile on the socket pipe and fasten it to the table.
3. Place the extra flange on the socket pipe and fasten it to the U-profile with the included screws.
4. Place the extraction arm on the socket pipe.
Make sure the internal spring goes into the socket pipe.
5. Follow the mounting instructions for the extraction arm.

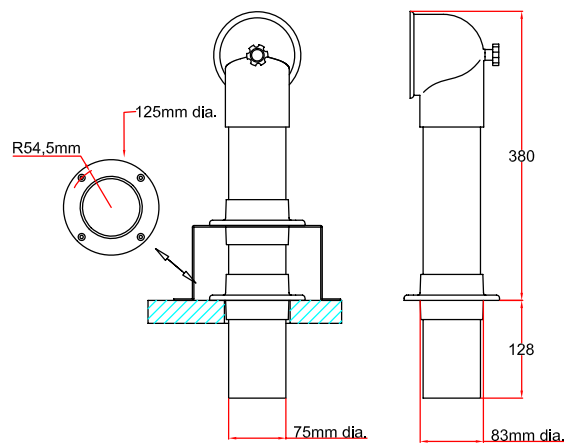




Table mounted option with U-profile under table

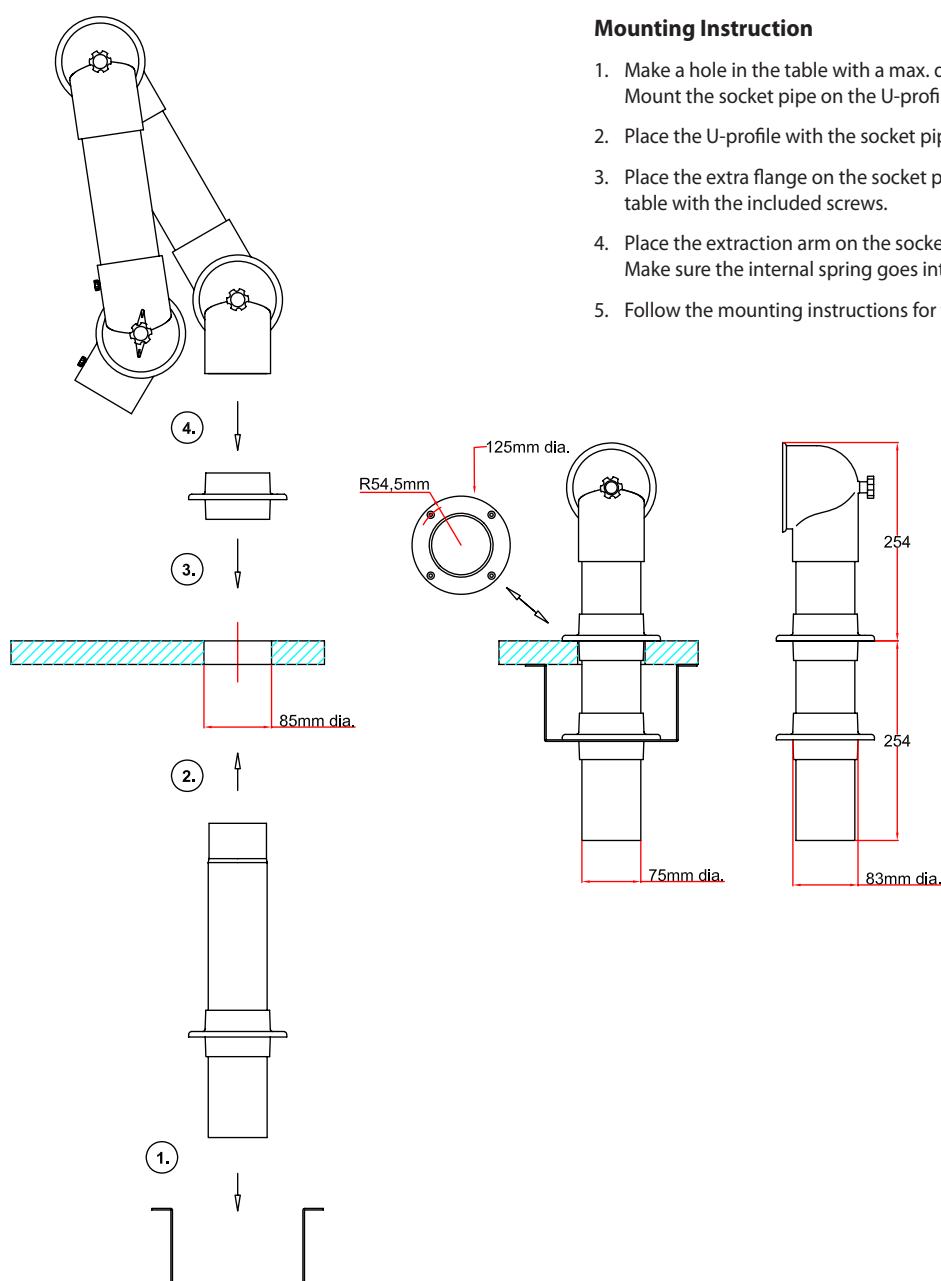
U-profile under table

System 75 mounted in table with U-profile below table.

Accessory

U-profile, Part No.: 30-75-5-4 /-5-5

Dimensions





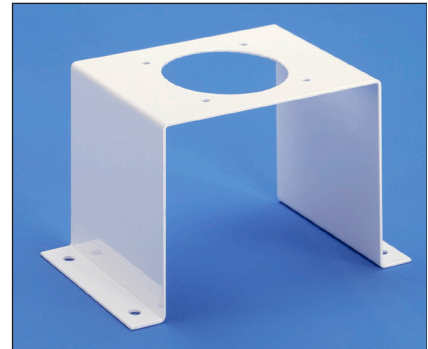
U-profile

Technical Description

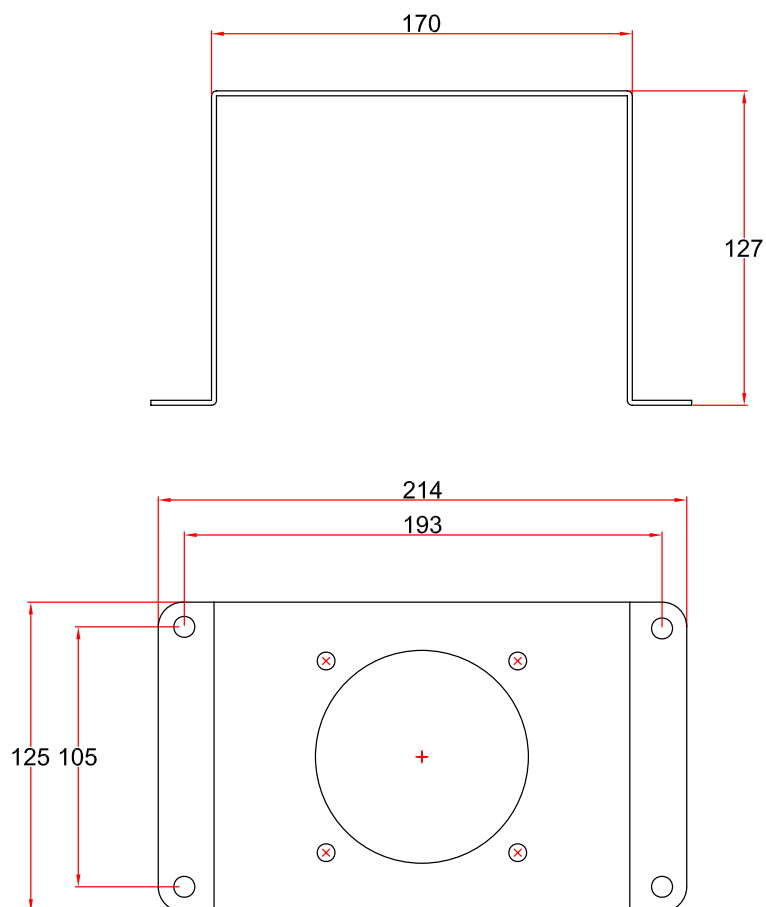
Part Nos.: 30-75-5-4 /-5 -5

Used for reinforcement of the socket pipe when table mounting a System 75 extraction arm in table plate.
 The U-profile can be placed both above and below the table.
 Made of steel with a white powder coated surface and an extra flange.
 The flange is available in white or red. Other colours for the U-profile is available on request.

Colour of flange	Part No.
Red PP	30-75-5-4
White PP	30-75-5-5



Dimensions



Spare Parts



SYSTEM 25

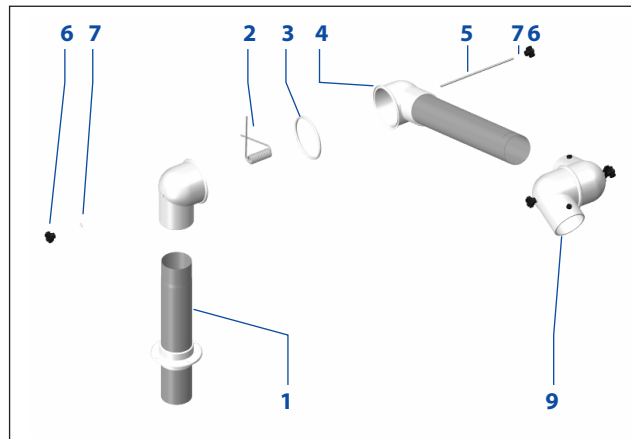
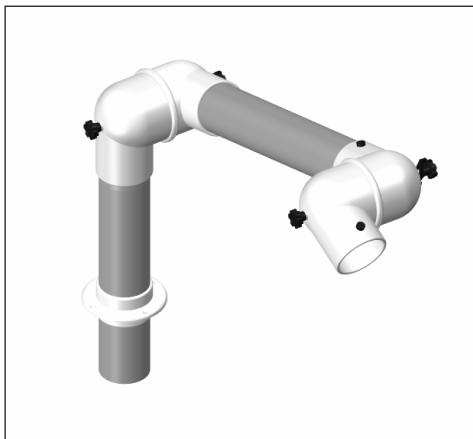
SYSTEM 50

SYSTEM 63

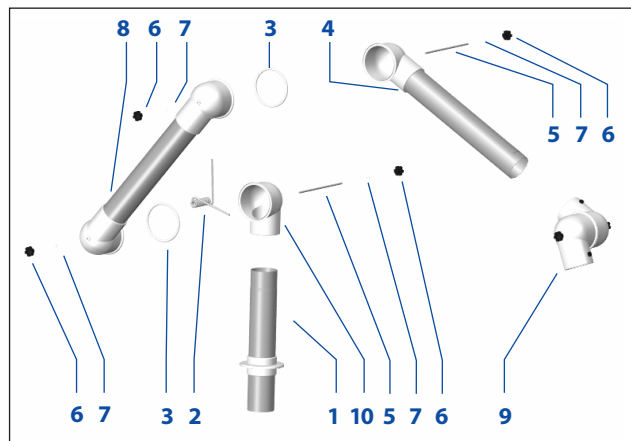
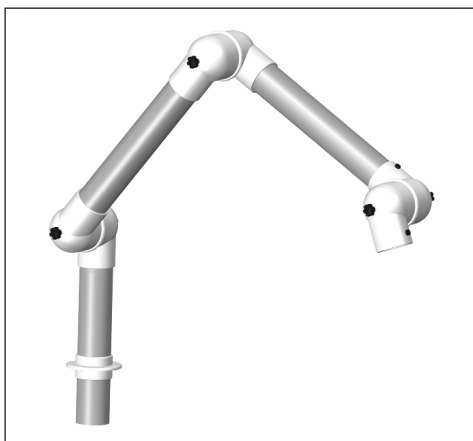
SYSTEM 75 AL

SYSTEM 100

(A) 75-35-1 (B) 75-45-1 (C) 75-55-1



(D) 75-3535-1 (E) 75-5545-1 (F) 75-6555-1 (G) 75-9065-1



Spare Parts List – see next page

Spare Parts List



Pos.	Product No.	Red	White	Joint
A	75-35-1	-4	-5	2-Joint
B	75-45-1	-4	-5	2-Joint
C	75-55-1	-4	-5	2-Joint
D	75-3535-1	-4	-5	3-Joint
E	75-5545-1	-4	-5	3-Joint
F	75-5545-1	-4	-5	3-Joint
G	75-9065-1	-4	-5	3-Joint

Pos.	Part No.	Description	A	B	C	D	E	F	G
			[pieces applied]						
1	3-7540-1-4 /-5	C-pipe TM 400	1	1	1	1	1	1	1
2	5-75-2-4-01	Spring 4 mm (2-Joint)		1	1				
2	5-75-3-4-01	Spring 4 mm				1			
2	5-75-3-5-01	Spring 5 mm					1	1	
2	5-75-3-6-01	Spring 6 mm							1
3	5-100-6	O-ring	1	1	1	2	2	2	2
4	3-7535-9-4 /-5	B-pipe 350	1			1			
4	3-7545-9-4 /-5	B-pipe 450		1			1		
4	3-7555-9-4 /-5	B-pipe 550			1			1	
4	3-7565-9-4 /-5	B-pipe 650							1
5	5-75-5-211	Threaded Stay	1	1	1	2	2	2	1
5	5-75-8-210	Threaded Stay, 8 mm							1
6	5-75-5	Thumbscrew, 5 mm	2	2	2	4	4	4	4
7	5-75	Teflon Washer	2	2	2	4	4	4	4
8	3-7535-8-4 /-5	A-pipe 350				1			
8	3-7555-8-4 /-5	A-pipe 550					1		
8	3-7565-8-4 /-5	A-pipe 650						1	
8	3-7590-8-4 /-5	A-pipe 900							1
9	4-75-4 /-5	Joint with damper*	1	1	1	1	1	1	1
10	4-755-4 /-5	Joint Ø5	1	1	1	1	1	1	1

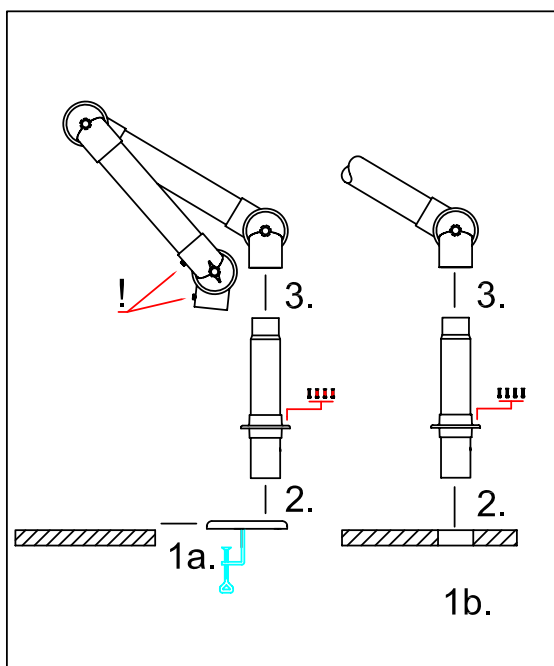
*) Spare Parts List for Joint with Damper – see General Information

When ordering spare parts please quote:

Product No.	eg.:	75-55-1-5 (white)
Description	-	B-pipe 550
Part No.	-	3-7555-9-5
Quantity	-	1 pc.

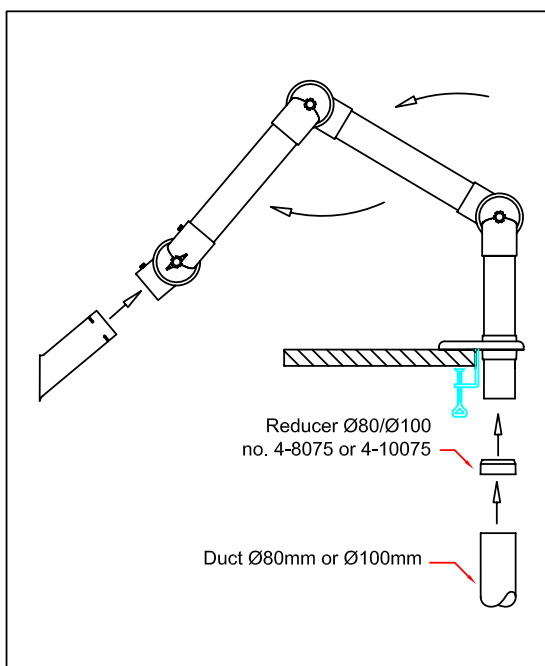
If you wish to customize the arm with a spare part which is not a constituent part of the particular model, please contact your Alsident dealer.

Mounting Instruction


Fig. 1:

On account of the packaging the extraction arm is delivered in two parts.

- 1a. Mount the table bracket on the edge of the table and tighten the clamps.
- 1b. Make a hole in the table with a diameter of 85mm where the extraction arm is to be placed.
2. Place the socket pipe in the hole of the table/bracket and fasten the flange with the included screws.
3. Place the joint of the extraction arm on the socket pipe. Be aware that the spring goes into the pipe and the fingerscrews (!) face forward.

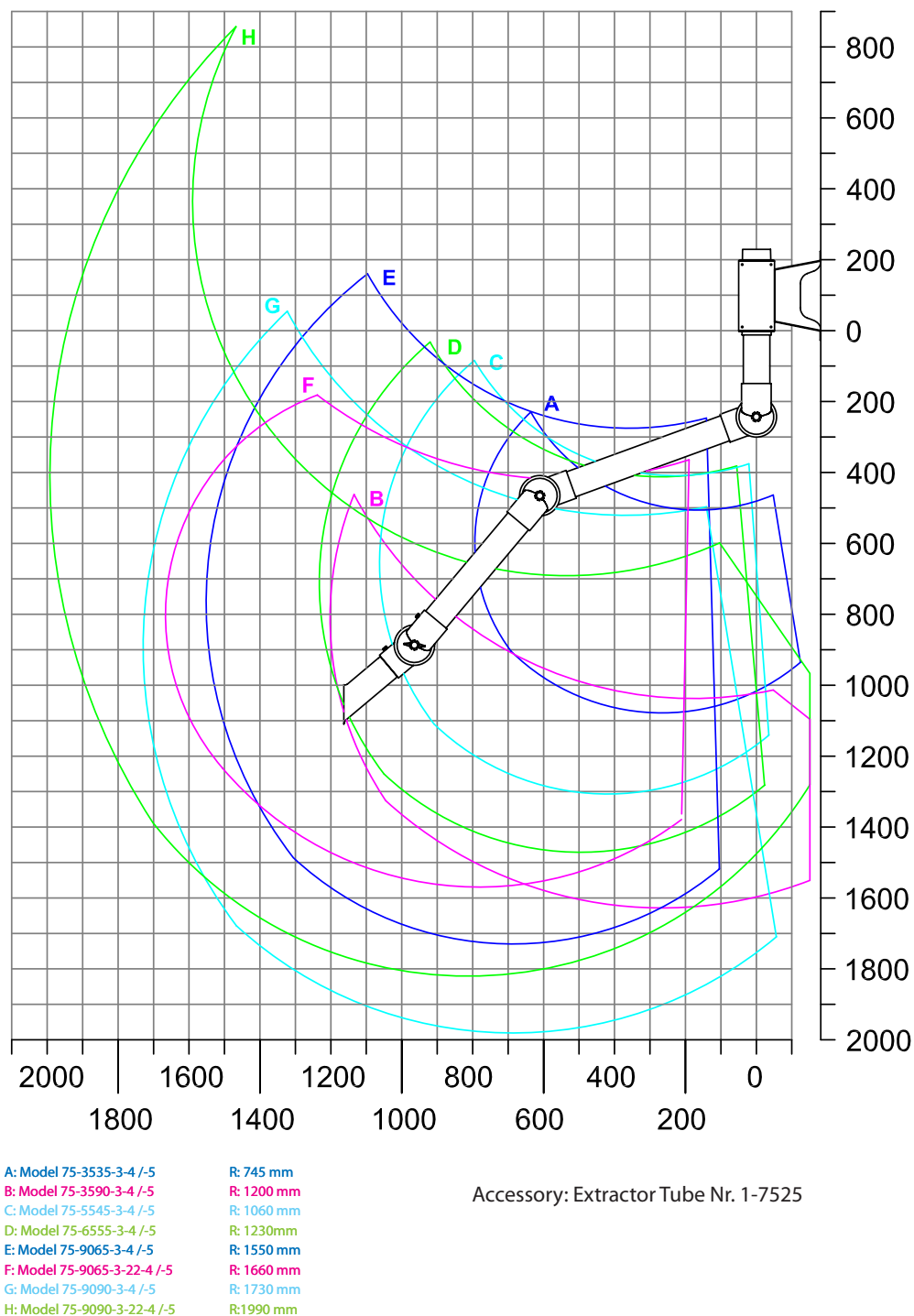

Fig. 2:

1. Connect the extraction arm to the main ventilation duct with the Alsident® reducer.
2. Unfold the extraction arm in the direction of the arrows.
3. Place the connection pipe of the accessory in the joint.
4. Turn the slit on the connection pipe towards the small fingerscrew on the joint. When screwed in the fingerscrew will hold the accessory in place in the joint.
5. Finally make sure the damper is open.
6. The extraction arm is now ready for use.



Working Area

Wall Mounted with Extractor Tube



Note:

The working area of the arm is defined from the center of the opening of the accessory.

The working area changes according to type of accessory and positioning.

When choosing the arm we recommend that the stationary working position of the accessory is not placed in the highest or lowest part of the working area.

(All measurements in mm)

Mounting Options



Wall Mounted Option

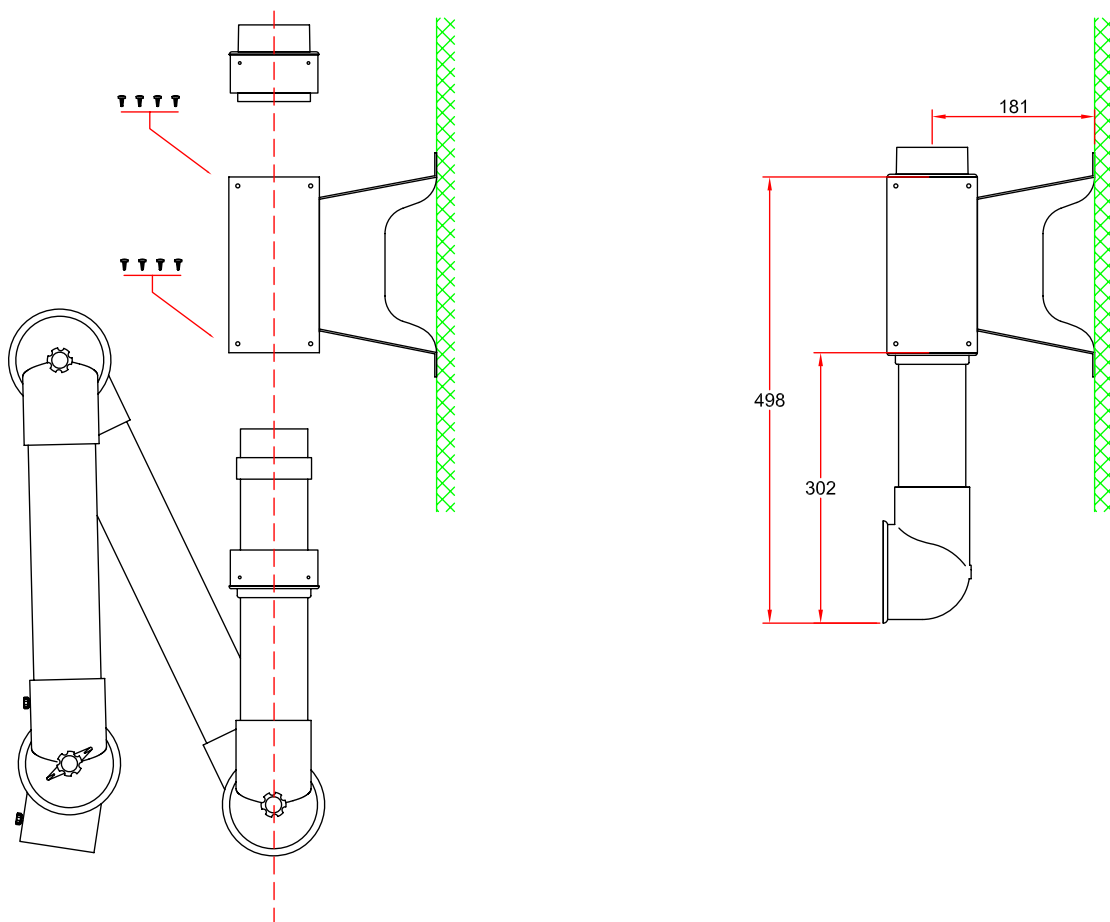
Wall Mounted

System 75 Extraction Arm – wall mounted with Wall Bracket

Accessory:

Wall Bracket, Part No.: 2-195

Dimensions



(All measurements in mm)



Wall bracket

Technical Description

Part Nos.: 2-195 and 2-195-10-5

Used for System 75 Wall mounted Extraction Arms.

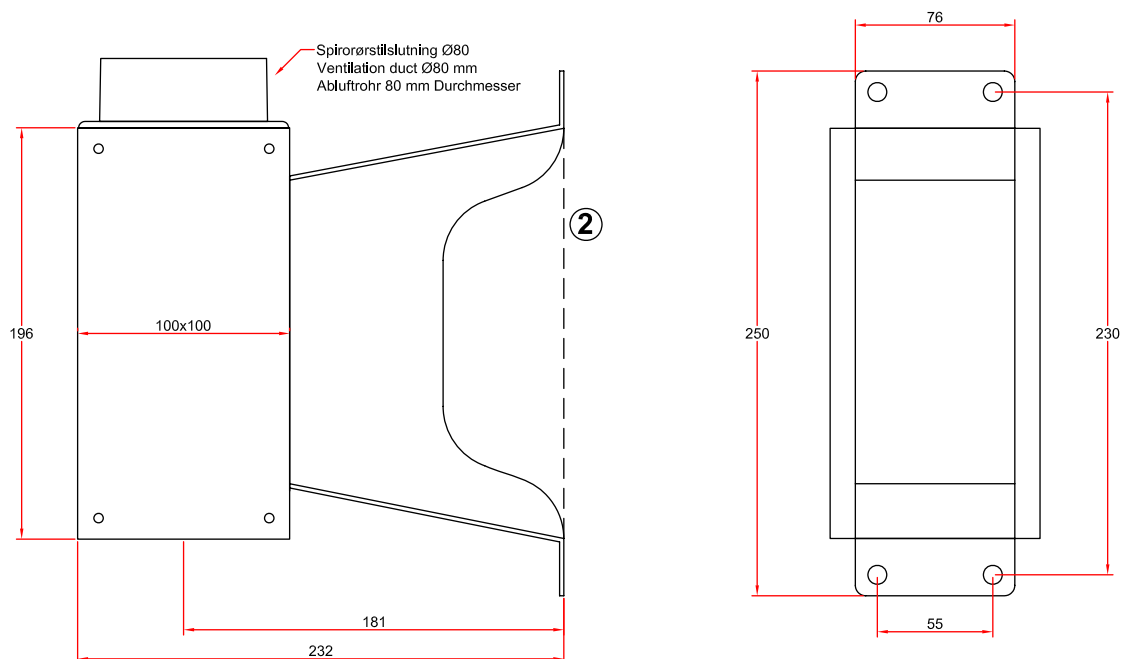
Made of steel with a white polyester powder-coating on all surfaces

Other colours and acid-proof stainless steel (AISI 316L) available on request.

Colour	Open sides	Closed sides
White	2-195	2-195-10-5



Dimensions



(All measurements in mm)

Spare Parts



SYSTEM 25

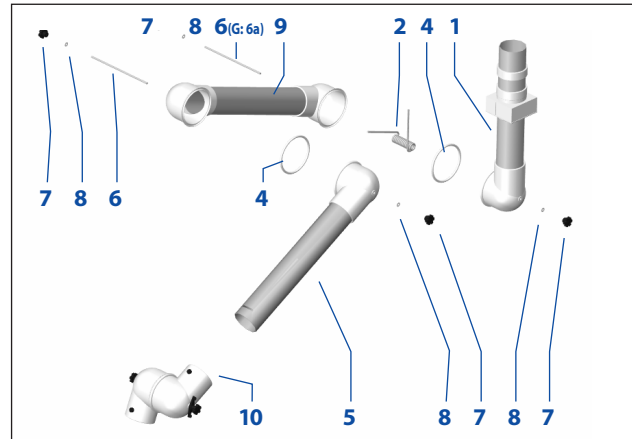
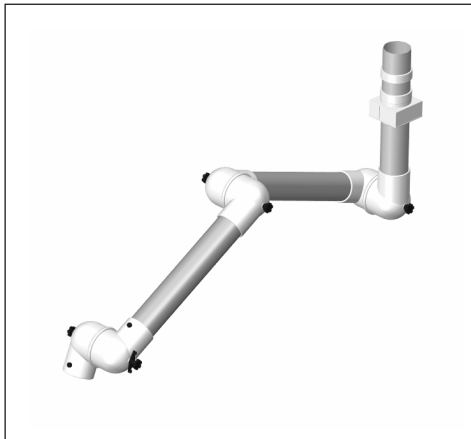
SYSTEM 50

SYSTEM 63

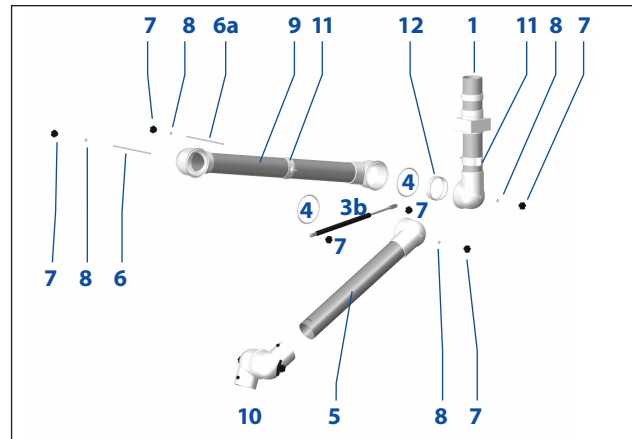
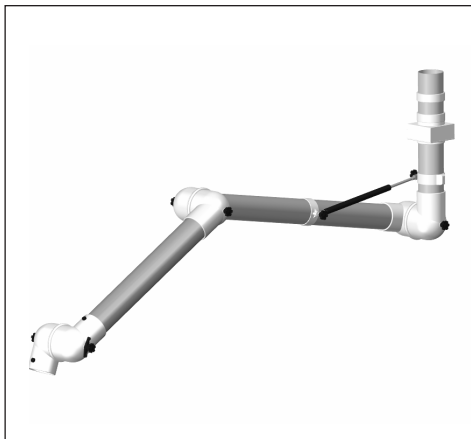
SYSTEM 75 AL

SYSTEM 100

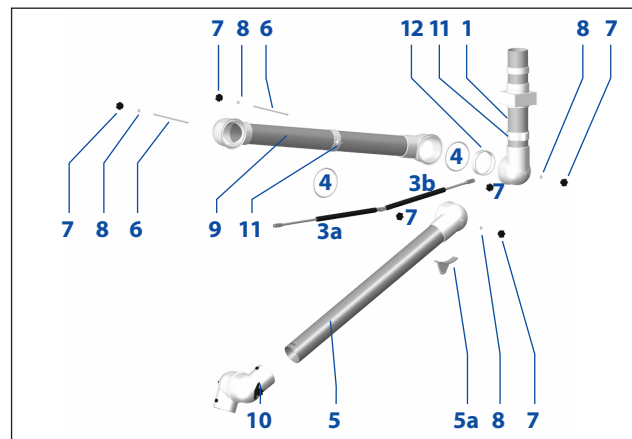
(A) 75-3535-3 (B) 75-3590-3 (C) 75-5545-3 (D) 75-6555-3 (E) 75-9065-3 (G) 75-9090-3



(F) 75-9065-3-22



(H) 75-9090-3-22



Spare Parts List – see next page

Spare Parts List



Pos.	Product No.	Red	White	Joint
A	75-3535-3	-4	-5	3-joint
B	75-3590-3	-4	-5	3-joint
C	75-5545-3	-4	-5	3-joint
D	75-6555-3	-4	-5	3-joint
E	75-9065-3	-4	-5	3-joint
F	75-9065-3-22	-4	-5	3-joint
G	75-9090-3	-4	-5	3-joint
H	75-9090-3-22	-4	-5	3-joint

Pos.	Part No.	Description	A [pieces applied]	B	C	D	E	F	G	H
1	3-7540-2-4 /-5	C-pipe CM 400	1	1	1	1	1	1	1	1
2	5-75-2-4-01	Spring TM 4 mm 2-Joint		1					1	
2	5-75-3-4-00	Spring WM/CM 4 mm	1							
2	5-75-3-5-00	Spring WM/CM 5 mm		1	1	1				
2	5-75-3-6-00	Spring WM/CM 6 mm					1			
2	5-75-3-6,5-50	Spring WM/CM 6,5 mm							1	
3a	800-100-100-1-050	Gas Spring 100N Push								1
3b	800-100-150-2-050	Gas Spring 150N Pull						1		1
4	5-100-6	O-ring	2	2	2	2	2	2	2	2
5	3-7535-9-4 /-5	B-pipe 350	1							
5	3-7545-9-4 /-5	B-pipe 450			1					
5	3-7555-9-4 /-5	B-pipe 550				1				
5	3-7565-9-4 /-5	B-pipe 650					1	1		
5	3-7590-9-4 /-5	B-pipe 900		1					1	1
5a	4-100-01-5	Angle brace for joint B								1
6	5-75-5-211	Threaded Stay	2	2	2	2	2	2	1	2
6a	5-75-8-210	Threaded Stay, 8 mm							1	
7	5-75-5	Thumbscrew, 5 mm	4	4	4	4	4	6	4	6
8	5-75	Teflon Washer	4	4	4	4	4	4	4	4
9	3-7535-8-4 /-5	A-pipe 350	1	1						
9	3-7555-8-4 /-5	A-pipe 550			1					
9	3-7565-8-4 /-5	A-pipe 650				1				
9	3-7590-8-4 /-5	A-pipe 900					1		1	
9	3-7590-0-8-4 /-5	A-pipe 900 gas spring						1		1
10	4-75-4 /-5	Joint with damper*	1	1	1	1	1	1	1	1
11	800-4-75-14-0-5	Ring for gas spring						2		2
12	800-4-75-14	Reinforcement ring						1		1

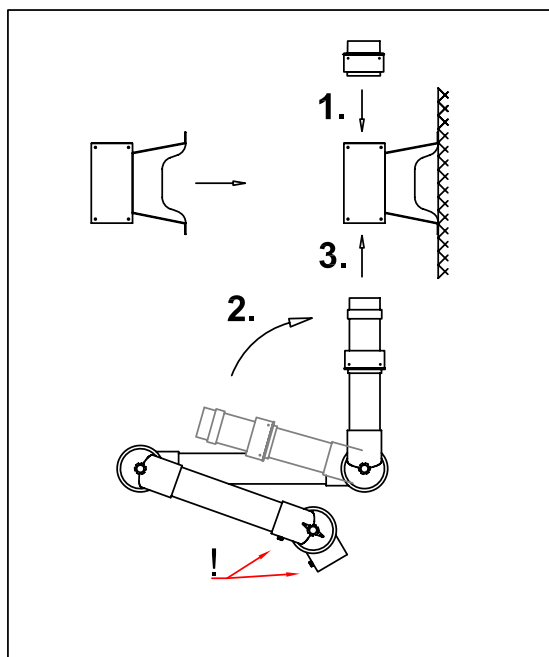
When ordering spare parts please quote:

Product No. eg.: 75-3535-3-5 (white)
 Description - A-pipe 350
 Part No. - 3-7535-8-5
 Quantity - 1 pc.

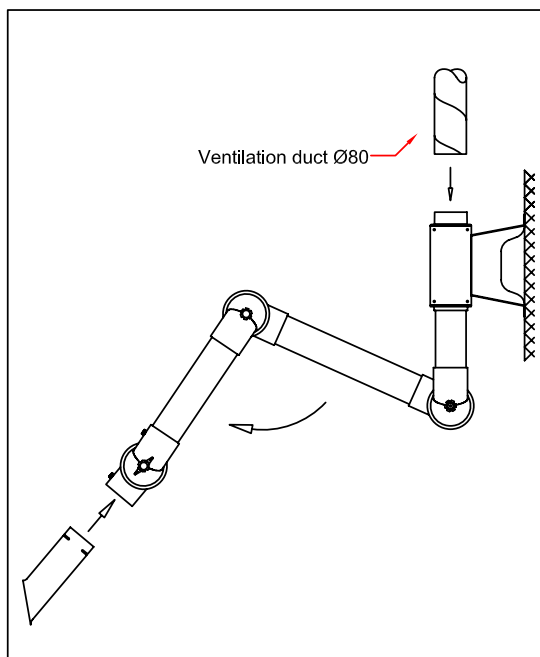
If you wish to customize the arm with a spare part which is not a constituent part of the particular model, please contact your Alsident dealer.

Mounting Instruction

With internal spring


Fig. 1:

1. Fasten the wall bracket solidly to the wall or column. When mounting the wall bracket be aware of the considerable strain the operation of the arm will transmit to the bracket.
2. Place the other square-guide in the top of the bracket (1) and fasten it to the wall bracket with the included screws.
3. Considering the internal spring, it is important to turn the socket pipe in the direction of the arrow (2) and that the fingerscrews (!) are faced forward.
4. Place the socket pipe in the wall bracket (3) and fasten the square-guide with the included screws.
5. The extraction arm can be turned 190° in the wall bracket.


Fig. 2:

1. Connect the main ventilation duct (80 mm dia.) directly to the top of the wall bracket.
2. Unfold the extraction arm in the direction of the arrow.
3. Place the connection pipe of the accessory in the joint. Turn the slit on the connection pipe towards the small fingerscrew on the joint. When screwed in the fingerscrew will hold the accessory in place in the joint.
4. Finally make sure the damper is open.
5. The extraction arm is now ready for use.



Mounting Instruction

With gas spring

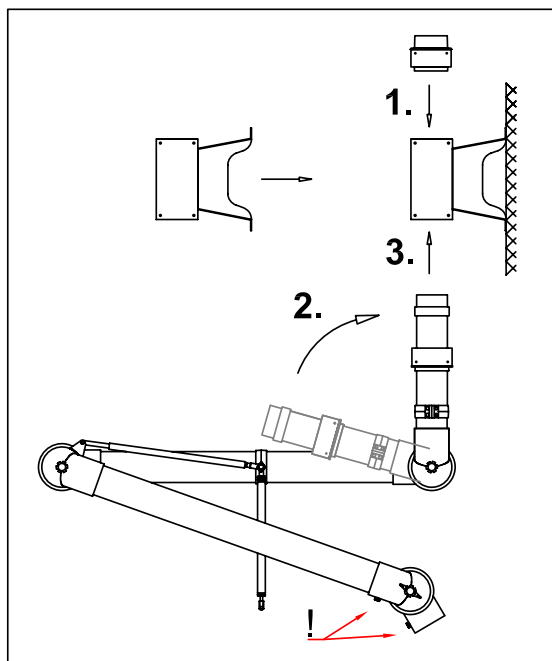


Fig. 1:

1. Fasten the wall bracket solidly to the wall or column. When mounting the wall bracket be aware of the considerable strain the operation of the arm will transmit to the bracket.
2. Place the other square-guide in the top of the bracket (1) and fasten it to the bracket.
3. When unfolding the extraction arm, make sure the socket pipe is turned in the direction of the arrow (2) and that the fingerscrews (!) are faced forward.
4. Place the socket pipe in the hole of the bracket (3) and fasten the square-guide with the included screws.
5. The extraction arm can be turned 190° in the wall bracket.

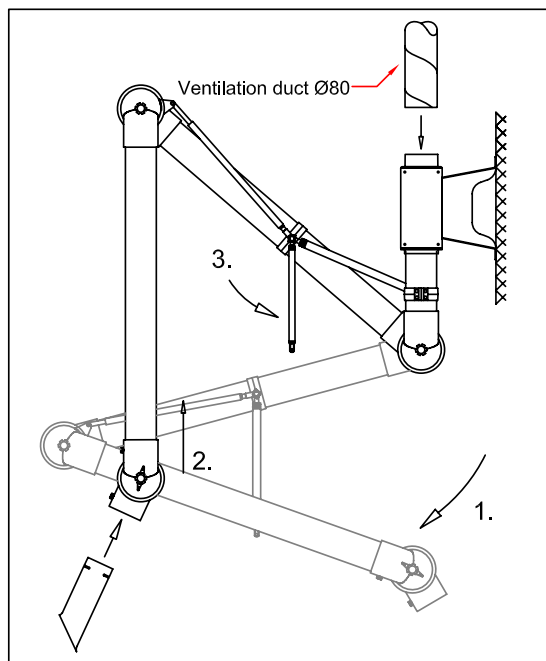
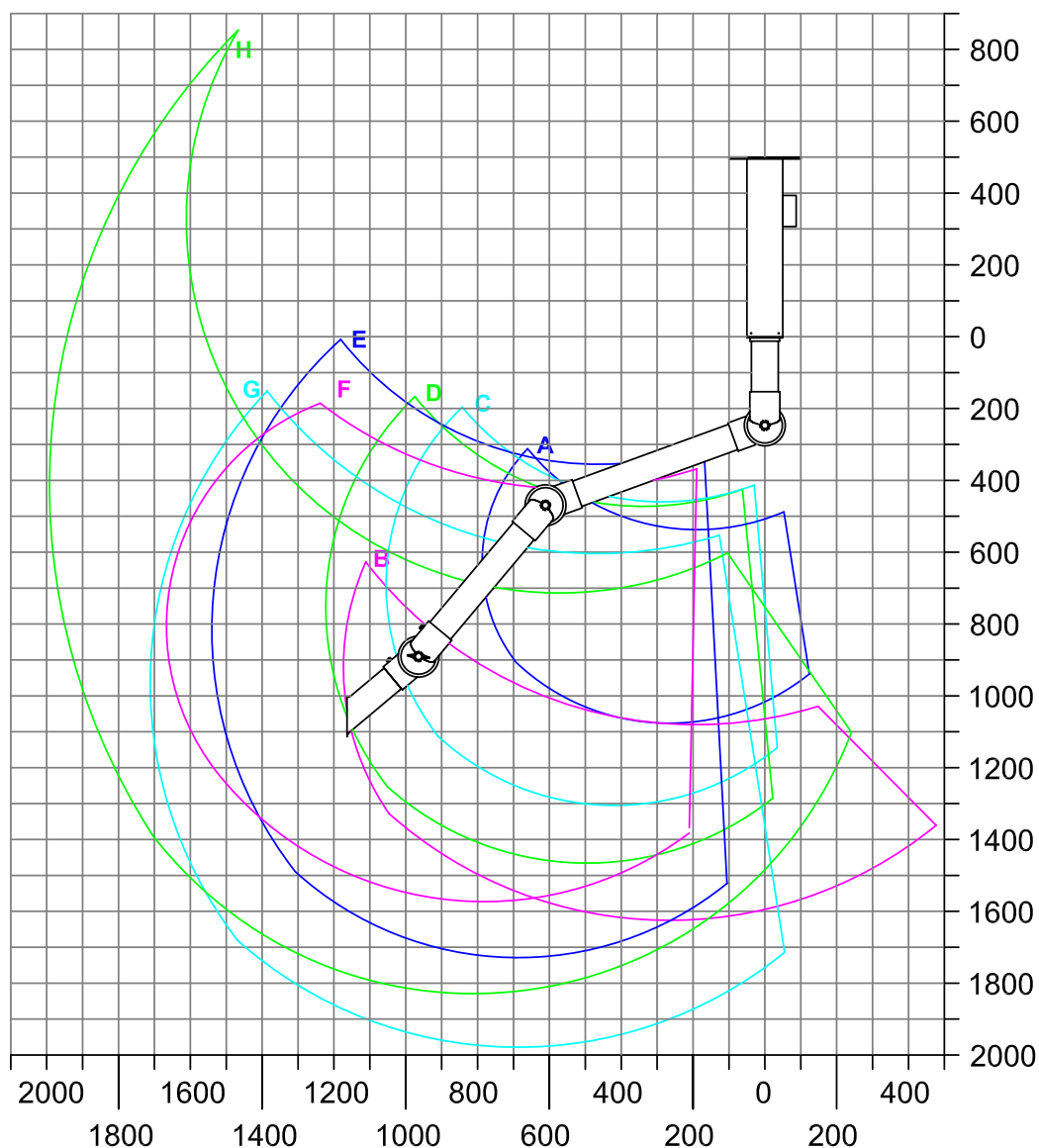


Fig. 2:

1. Unfold the extraction arm in the direction of the arrow (1).
2. Push the extraction arm towards vertical position (2).
3. Turn the gas spring towards the fitting on the socket pipe and fasten it with the fingerscrew (3).
4. Connect the main ventilation duct (80 mm dia.) directly to the top of the wall bracket.
5. Place the connection pipe of the accessory in the joint. Turn the slit on the connection pipe towards the small fingerscrew. When screwed in the fingerscrew will hold the accessory in place in the joint.
6. Finally make sure the damper is open.
7. The extraction arm is now ready for use.

Working Area

Ceiling Mounted Option



A: Model 75-3535-3-4 /-5	R: 795 mm
B: Model 75-3590-3-4 /-5	R: 1200 mm
C: Model 75-5545-3-4 /-5	R: 1060 mm
D: Model 75-6555-3-4 /-5	R: 1230 mm
E: Model 75-9065-3-4 /-5	R: 1550 mm
F: Model 75-9065-3-22-4 /-5	R: 1660 mm
G: Model 75-9090-3-4 /-5	R: 1730 mm
H: Model 75-9090-3-22-4 /-5	R: 1990 mm

Accessory: Extractor Tube Part No. 1-7525-7-5

Note:

The working area of the arm is defined from the center of the opening of the accessory.

The working area changes according to type of accessory and positioning.

When choosing the arm we recommend that the stationary working position of the accessory is not placed in the highest or lowest part of the working area.

(All measurements in mm)

Mounting Options



Ceiling Mounted Option

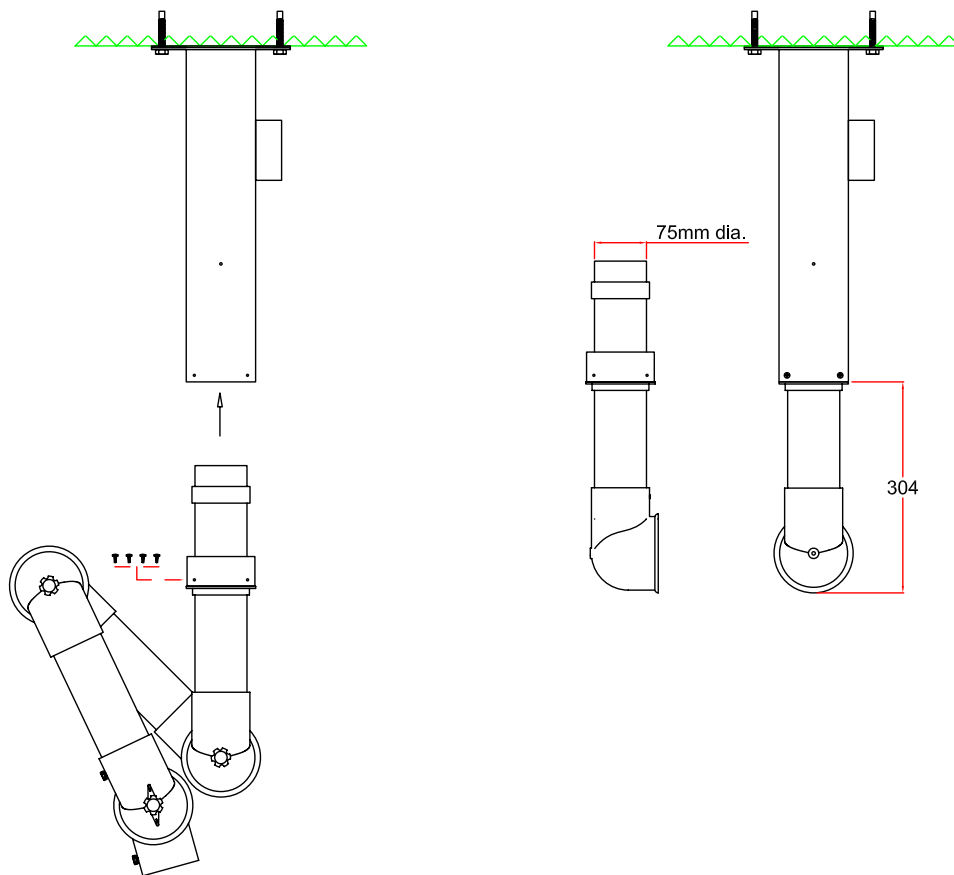
Ceiling Mounted

System 75 Extraction Arm in a ceiling column with side connection.

Accessory:

Ceiling Column, Part No. depending on lengths.

Dimensions



(All measurements in mm)

Ceiling Column

Technical Description



Columns

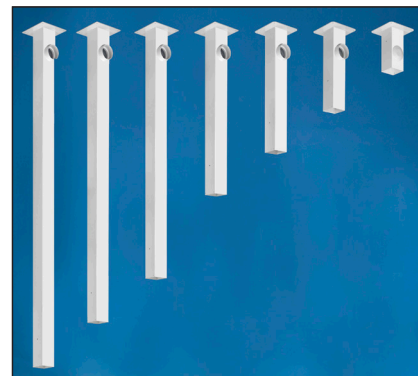
Used for mounting the System 75 Ceiling Mounted Extraction Arms.
The ceiling column is made of steel with a white or black polyester powder coating. Available in two models with side connection or top connection to duct. For standard lengths see below.

Other lengths, colours or acidproof stainless steel (AISI 316L) available on request.

Connection diameter

With side connection: 80 mm

With top connection: max.100 mm



Top connection, Part No.:

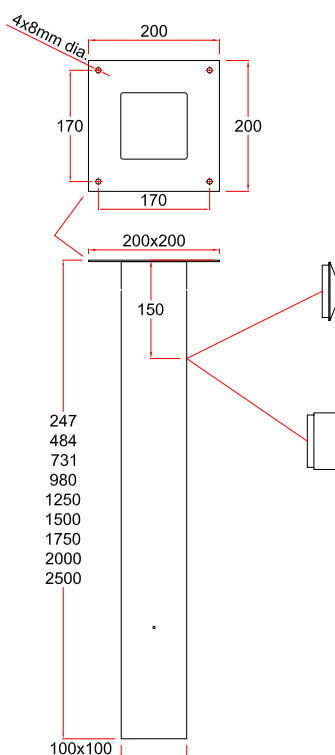
Length [mm]	Weight app. [kg]	White	Black
250	2.0	2-250-20	2-250-050-20
500	3.0	2-500-20	2-500-050-20
750	3.8	2-750-20	2-750-050-20
1000	4.5	2-1000-20	2-1000-050-20
1250	5.4	2-1250-20	- *
1500	6.1	2-1500-20	- *
1750	7.1	2-1750-20	- *
2000	7.9	2-2000-20	- *
2500	9.4	2-2500-20	- *

Side connection, Part No.:

Length [mm]	Weight app. [kg]	White	Black
250	2.0	-	-
500	3.0	2-500-80	2-500-050-80
750	3.8	2-750-80	2-750-050-80
1000	4.5	2-1000-80	2-1000-050-80
1250	5.4	2-1250-80	- *
1500	6.1	2-1500-80	- *
1750	7.1	2-1750-80	- *
2000	7.9	2-2000-80	- *
2500	9.4	2-2500-80	- *

*) Black on request

Dimensions

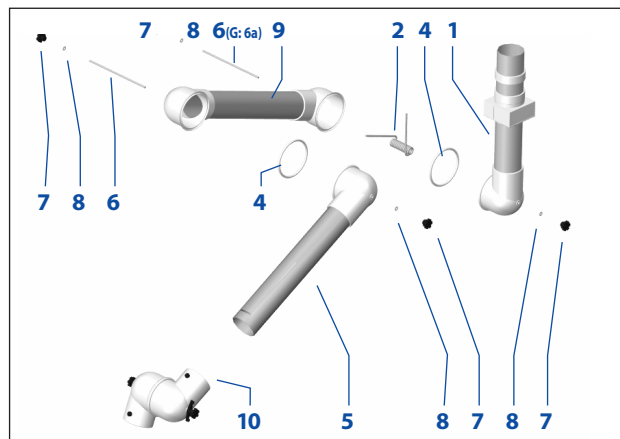
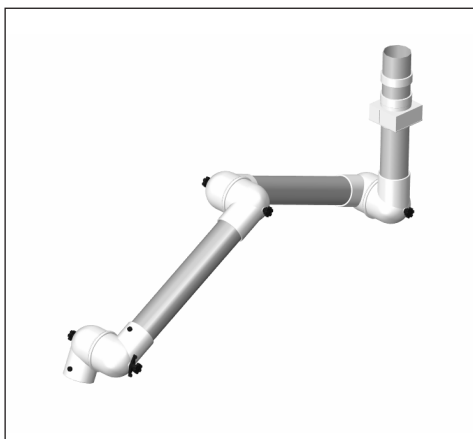


(All measurements in mm)

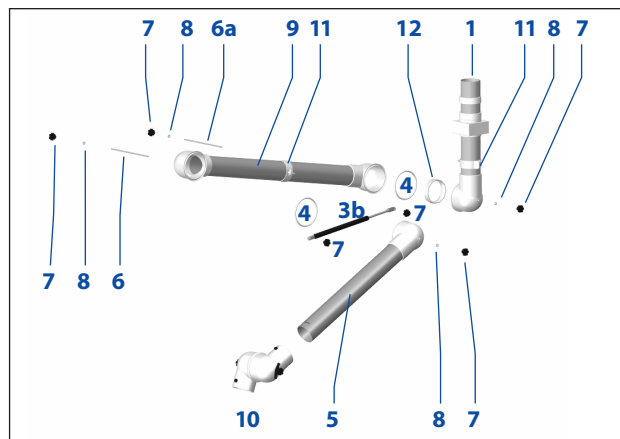
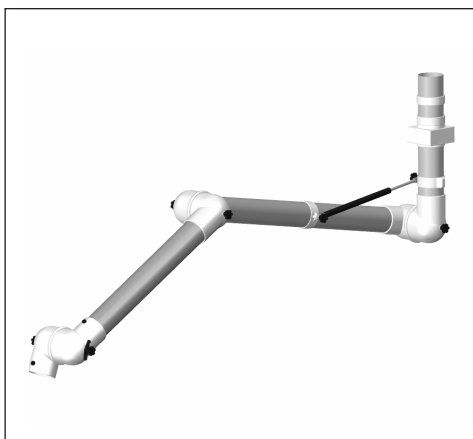
Spare Parts



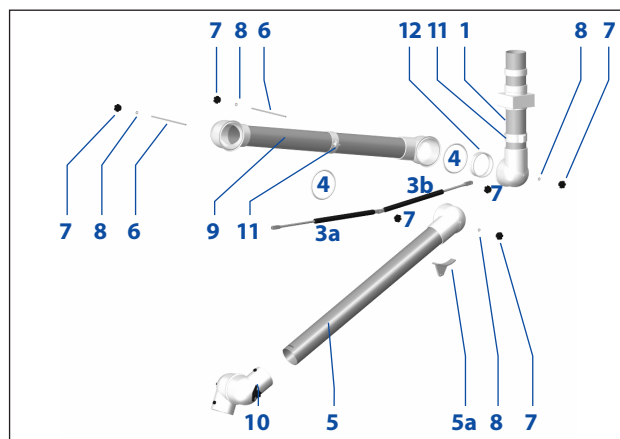
(A) 75-3535-3 (B) 75-3590-3 (C) 75-5545-3 (D) 75-6555-3 (E) 75-9065-3 (G) 75-9090-3



(F) 75-9065-3-22



(H) 75-9090-3-22



Spare Parts List – see next page

Spare Parts List



SYSTEM 25

SYSTEM 50

SYSTEM 63

SYSTEM 75 AL

SYSTEM 100

Pos.	Product No.	Red	White	Joint
A	75-3535-3	-4	-5	3-joint
B	75-3590-3	-4	-5	3-joint
C	75-5545-3	-4	-5	3-joint
D	75-6555-3	-4	-5	3-joint
E	75-9065-3	-4	-5	3-joint
F	75-9065-3-22	-4	-5	3-joint
G	75-9090-3	-4	-5	3-joint
H	75-9090-3-22	-4	-5	3-joint

Pos.	Part No.	Description	A [pieces applied]	B	C	D	E	F	G	H
1	3-7540-2-4 /-5	C-pipe CM 400	1	1	1	1	1	1	1	1
2	5-75-2-4-01	Spring TM 4 mm 2-Joint		1					1	
2	5-75-3-4-00	Spring WM/CM 4 mm	1							
2	5-75-3-5-00	Spring WM/CM 5 mm		1	1	1				
2	5-75-3-6-00	Spring WM/CM 6 mm					1			
2	5-75-3-6,5-50	Spring WM/CM 6,5 mm							1	
3a	800-100-100-1-050	Gas Spring 100N Push								1
3b	800-100-150-2-050	Gas Spring 150N Pull						1		1
4	5-100-6	O-ring	2	2	2	2	2	2	2	2
5	3-7535-9-4 /-5	B-pipe 350	1							
5	3-7545-9-4 /-5	B-pipe 450			1					
5	3-7555-9-4 /-5	B-pipe 550				1				
5	3-7565-9-4 /-5	B-pipe 650					1	1		
5	3-7590-9-4 /-5	B-pipe 900		1					1	1
5a	4-100-01-5	Angle brace for joint B								1
6	5-75-5-211	Threaded Stay	2	2	2	2	2	2	1	2
6a	5-75-8-210	Threaded Stay, 8 mm							1	
7	5-75-5	Thumbscrew, 5 mm	4	4	4	4	4	6	4	6
8	5-75	Teflon Washer	4	4	4	4	4	4	4	4
9	3-7535-8-4 /-5	A-pipe 350	1	1						
9	3-7555-8-4 /-5	A-pipe 550			1					
9	3-7565-8-4 /-5	A-pipe 650				1				
9	3-7590-8-4 /-5	A-pipe 900					1		1	
9	3-7590-0-8-4 /-5	A-pipe 900 gas spring						1		1
10	4-75-4 /-5	Joint with damper*	1	1	1	1	1	1	1	1
11	800-4-75-14-0-5	Ring for gas spring						2		2
12	800-4-75-14	Reinforcement ring						1		1

When ordering spare parts please quote:

Product No. eg.: 75-3535-3-5 (white)
 Description - A-pipe 350
 Part No. - 3-7535-8-5
 Quantity - 1 pc.

If you wish to customize the arm with a spare part which is not a constituent part of the particular model, please contact your Alsident dealer.



Mounting Instruction

With internal spring

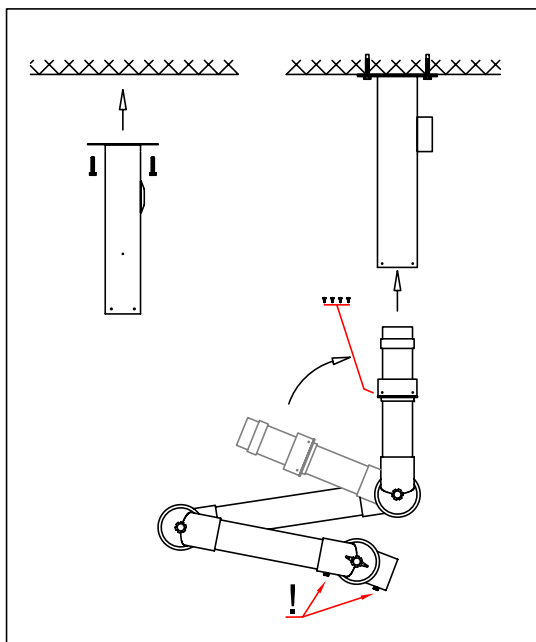


Fig. 1:

1. Mount the column under the ceiling.
2. The operation of the extraction arm will transmit a considerable strain to the column. The column must therefore be mounted on a solid ceiling.
3. Considering the internal spring, it is important to turn the socket pipe in the direction of the arrow and that the fingerscrews (!) are faced forward.
4. Place the socket pipe in the ceiling column and fasten the square-guide with the included screws.
5. The extraction arm can now be turned 360° in the column.

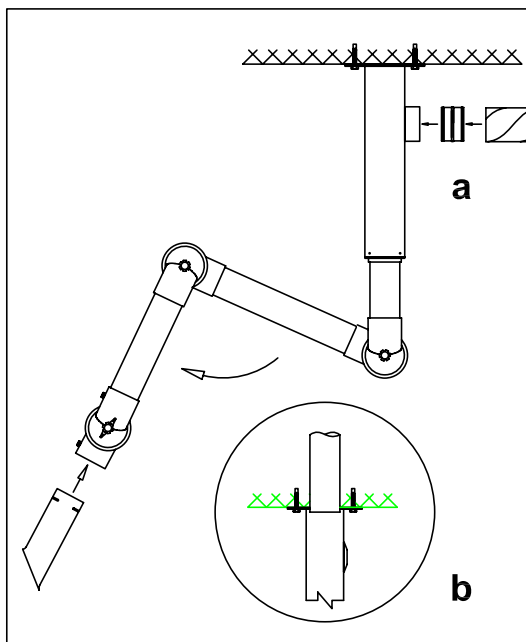
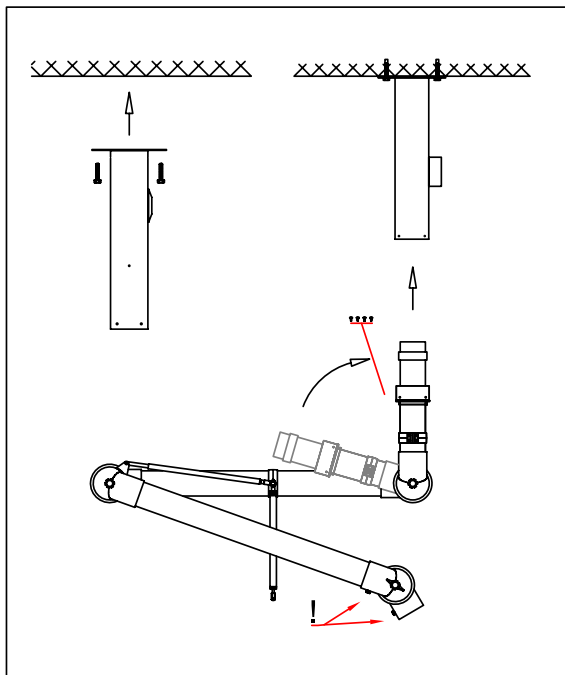


Fig. 2:

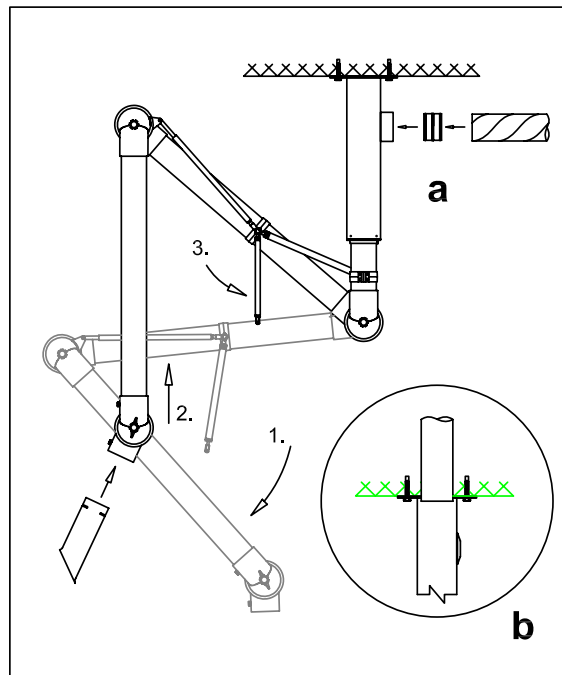
1. For side connection (fig. 2a) the main ventilation duct (80mm dia.) can be connected to the outlet on the side of the column with a nipple - or directly to the outlet.
For top connection (fig. 2b) the main ventilation duct is put through the ceiling and directly into the column. Make sure to tighten the gap between the ceiling and duct with a filler.
2. Unfold the extraction arm in the direction of the arrow.
3. Place the connection pipe of the accessory in the joint. Turn the small slit in the connection pipe towards the fingerscrew. When screwed in the fingerscrew will hold the accessory in place in the joint.
4. Finally make sure the damper is open.
5. The extraction arm is now ready for use.

Mounting Instruction

With gas spring


Fig. 1:

1. Mount the column under the ceiling.
2. The operation of the extraction arm will transmit a considerable strain to the column. The column must therefore be mounted on a solid ceiling.
3. When unfolding the extraction arm, make sure the socket pipe is turned in the direction of the arrow and the fingerscrews (!) are faced forward.
4. Place the socket pipe in the hole of the bracket and fasten the square-guide with the included screws.
5. The extraction arm can now be turned 360° in the column.


Fig. 2:

1. For side connection (fig. 2a) the main ventilation duct (80mm dia.) can be connected to the outlet on the side of the column with a nipple - or directly to the outlet.
For top connection (fig. 2b) the main ventilation duct is put through the ceiling and directly into the column. Make sure to seal the gap between the ceiling and duct with a filler.
2. Unfold the extraction arm in the direction of the arrow (1).
3. Push the extraction arm towards vertical position. This enables the gas spring to be mounted (2).
4. Turn the gas spring towards the fitting on the socket pipe and fasten it with the fingerscrew (3).
5. Place the connection pipe of the accessory in the joint. Turn the slit on the connection pipe towards the small fingerscrew. When screwed in the fingerscrew will hold the accessory in place in the joint.
6. Finally make sure the damper is open.
7. The extraction arm is now ready for use.